

PXE-13S

13-Slot PICMG 1.3 PCIe to PCI Bridge Backplane User Manual Ver. 5.0

1. USB1, USB2: External 4 Port USB Connectors From the Mainboard

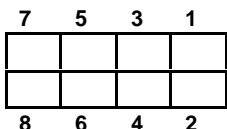

PIN	DESCRIPTION	PIN	DESCRIPTION
1	USBVCC	2	GND
3	DATA-	4	DATA+
5	DATA+	6	DATA-
7	GND	8	USBVCC

2. FAN1, FAN2, FAN3, FAN4: Fan Connector

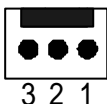

PIN	DESCRIPTION
1	GND
2	+12V
3	NC

3. ATXCTL1: Backplane to Mainboard ATX Power Control Connector

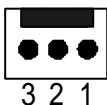

PIN	DESCRIPTION
1	GND
2	PSON#
3	5VSB

4. PWR2: This connector supports the AT-P10 power Connector

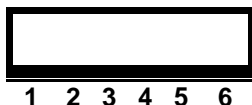

PIN	1	2	3	4	5	6
DESCRIPTION	+5V			GND		

5. PWRBTN: Power On Button



PIN	DESCRIPTION
1	GND
2	PWRBT#

6. RESET: Reset Button Connector



PIN	DESCRIPTION
1	GND
2	SHB_RST#

7. PWRGD: External Power Good Connector



PIN	DESCRIPTION
1	GND
2	PWRGD

8. SM-BUS: External System Management BUS Connector



PIN	DESCRIPTION
1	SMDATA
2	SMBCLK

9. CN1: PCIE X16 SDVO Control Signal Pin

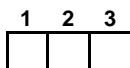

PIN	DESCRIPTION
1	EXP_EN
2	SDVO_CLK
3	SDVO_DAT

10. IOPWR: The I/O Power Connector indicators for controlling your CPU board

PIN	DESCRIPTION	PIN	DESCRIPTION
1	GND	2	-12V
3	+12V	4	GND
5	IPMB_DA	6	5VSB
7	GND	8	GND
9	IPMB_CL	10	5VSB
11	+5V	12	PWRGD
13	SMDAT	14	SHB_RST#
15	5VSB	16	GND
17	SMCLK	18	PSON#
19	+3.3V	20	PWRBT#

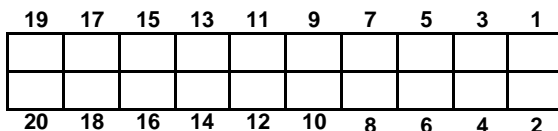

11. J1: Write Protect Setup

J1 are the EEPROM write protect pin of the PCI Express to PCI Bridge will allow EEPROM normal read/write operations when J1 held high. When the Jump is brought low and the EEPROM WPEN bit is “1”, all write operations to the status register are inhibited.



J1	DESCRIPTION
ON (Low)	Write Inhibited
OFF (High)	Normal Read/Write (default)

12. PCI routing table:

SIGNAL	REQ#	GNT#	IDSEL	INTA#	INTB#	INTC#	INTD#
PIN No.	B18	A17	A26	A6	B7	A7	B8
PCI1	REQ0#	GNT0#	AD31	B	C	D	A
PCI2	REQ1#	GNT1#	AD30	C	D	A	B
PCI3	REQ2#	GNT2#	AD29	D	A	B	C
PCI4	REQ3#	GNT3#	AD28	A	B	C	D

PCI Express to PCI Group A Routing

SIGNAL	REQ#	GNT#	IDSEL	INTA#	INTB#	INTC#	INTD#
PIN No.	B18	A17	A26	A6	B7	A7	B8
PCI_A1	REQ0#	GNT0#	AD16	A	B	C	D
PCI_A2	REQ1#	GNT1#	AD17	B	C	D	A
PCI_A3	REQ2#	GNT2#	AD18	C	D	A	B
PCI_A4	REQ3#	GNT3#	AD19	D	A	B	C

13. Notice:

- a. Recommend to use 6mm width spacer to install

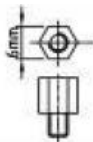

- b. Torsion must less than 6lb-inch

14. Dimension:

