

# PXE-13S

13-slot PICMG 1.3 PCIe to PCI Bridge Backplane

## Quick Installation Guide

Version 5.10

November, 2025

### Features

- 4 x Internal USB 2.0: by pin Header
- 1 x PCIe x16 Slot
- 3 x PCIe x1 Slots
- 8 x PCI Slot

### Packing List

- 1 x PXE-13S-R51 module
- 1 x QIG (Quick Installation Guide)

## Jumpers & Connectors

USB1, USB2: External 4 Port USB Connector from the Mainboard			
PIN NO.	Description	PIN NO.	Description
1	USBVCC	2	GND
3	DATA-	4	DATA+
5	DATA+	6	DATA-
7	GND	8	USBVCC

CN4: Voltage Connector	
PIN NO.	Description
1	+5V
2	-5V
3	-12V
4	+12V
5	GND

FAN1, FAN2, FAN3, FAN4: FAN Connector	
PIN NO.	Description
1	GND
2	+12V
3	NC

ATXCTL1: Backplane to Mainboard ATX Power Control Connector	
PIN NO.	Description
1	GND
2	PSON#
3	5VSB

PWRBTN: Power on Button	
PIN NO.	Description
1	GND
2	PWRBT#

RESET: Reset Button Connector	
PIN NO.	Description
1	GND
2	SHB_RST#

<b>PWRGD: External Power Good Connector</b>	
PIN NO.	Description
1	GND
2	PWRGD

<b>SM-BUS: External System Management BUS Connector</b>	
PIN NO.	Description
1	SMDATA
2	SMBCLK

<b>CN1: PCIE x16 SDVO Control Signal Pin</b>	
PIN NO.	Description
1	EXP_EN
2	SDVO_CLK
3	SDVO_DAT

<b>IOPWR: The I/O Power Connector indicators for controlling your CPU board</b>			
PIN NO.	Description	PIN NO.	Description
1	GND	2	-12V
3	+12V	4	GND
5	IPMB_DA	6	5VSB
7	GND	8	GND
9	IPMB_CL	10	5VSB
11	+5V	12	PWRGD
13	SMDAT	14	SHB_RST#
15	5VSB	16	GND
17	SMCLK	18	PSOEN#
19	+3.3V	20	PWRBT#

## J1: Write Protect Setup

J1 is the EEPROM write protect pin of the PCI Express to PCI Bridge will allow EEPROM normal read/write operations when J1 held high. When the Jump is brought low and the EEPROM WPEN bit is "1", all write operations to the status register is inhibited.

<b>J1:</b>	
PIN NO.	Description
ON (Low) Write Inhibited	ON (Low) Write Inhibited
OFF (High)	OFF (High)

PCI routing table

SIGNAL	REQ#	GNT#	IDSEL	INTA#	INTB#	INTC#	INTD#
PIN NO.	B18	A17	A26	A6	B7	A7	B8
PCI1	REQ0#	GNT0#	AD31	B	C	D	A
PCI2	REQ1#	GNT1#	AD30	C	D	A	B
PCI3	REQ2#	GNT2#	AD29	D	A	B	C
PCI4	REQ3#	GNT3#	AD28	A	B	C	D

PCI Express to PCI Group A Routing

SIGNAL	REQ#	GNT#	IDSEL	INTA#	INTB#	INTC#	INTD#
PIN NO.	B18	A17	A26	A6	B7	A7	B8
PCI_A1	REQ0#	GNT0#	AD31	A	B	C	D
PCI_A2	REQ1#	GNT1#	AD30	B	C	D	A
PCI_A3	REQ2#	GNT2#	AD29	C	D	A	B
PCI_A4	REQ3#	GNT3#	AD28	D	A	B	C



**NOTE:**

- a. Recommend to use 6mm width spacer to install

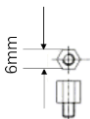

- b. Torsion must less than 6lb-inch

Get more information:



PXE-13S



IEI Resource Download Center

Dimensions (Unit: mm)

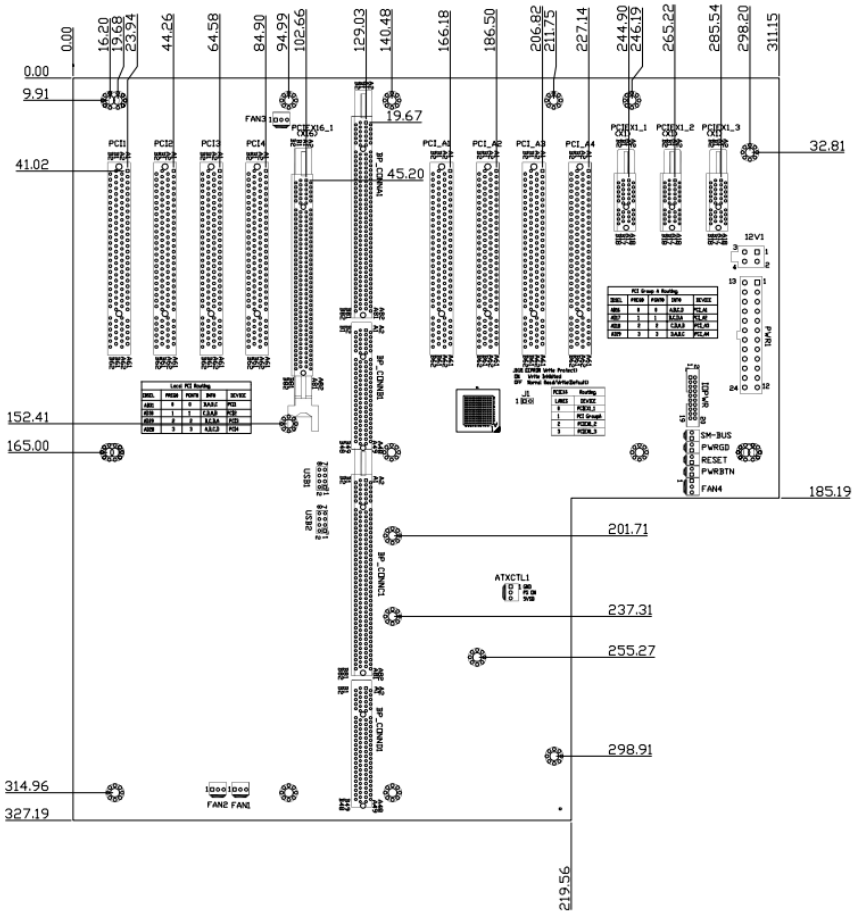

## Safety Instructions



Warning! Read the user manual before connecting the system to the power source.

Warning! To prevent the system from overheating, do not operate it in an area that exceeds the maximum operating temperature described in the user manual.

Warning! Ultimate disposal of this product should be handled according to all national laws and regulations.

## Support



### IEI Support URL

[http://new.ieiworld.com/tw/online\\_support\\_form](http://new.ieiworld.com/tw/online_support_form)

## Compliance



According to the requirement of the WEEE legislation the following user information is provided to customers for all branded IEI Electronics products subject to the WEEE directive.

This symbol on the product or on its packaging indicates that this product must not be disposed of with your other household waste. Instead, it is your responsibility to dispose of your waste equipment by handing it over to a designated collection point for the recycling of waste electrical and electronic equipment. The separate collection and recycling of your waste equipment at the time of disposal will help to conserve natural resources and ensure that it is recycled in a manner that protects human health and the environment. For more information about where you can drop o- your waste equipment for recycling, please contact your local city office, your household waste disposal service or the shop where you purchased the product.

### Headquarters

#### IEI Integration Corp.

No. 29, ZhongXing Rd., Xizhi Dist.,  
New Taipei City 221, Taiwan  
TEL: +886-2-8691-6798/+886-2-2690-2098  
FAX: +886-2-6616-0028  
sales@ieiworld.com  
www.ieiworld.com

### America

#### IEI Technology USA Corp.

138 University Parkway, Pomona,  
CA 91768, USA  
Tel:+1-909-595-2819  
Fax:+1-909-595-2816  
sales@usa.ieiworld.com  
usa.ieiworld.com

### China

#### IEI Integration (Shanghai) Corp.

No. 515, Shen Fu Rd., Xin Zhuang Industrial Develop Zone,  
Shanghai, 201108, China  
Tel:+86-21-3116-7799  
Fax:+86-21-3462-7797  
sales@ieiworld.com.cn  
www.ieiworld.com.cn