

# IP-3S

3-slot Backplane with 2 PCI and one ISA Bus

## Quick Installation Guide

Version 4.00

November, 2025

### Features

- 2 x PCI Slot
- 1 x ISA Slot
- Support AT mode

### Packing List

- 10 x IP-3S-RS-R40 module
- 1 x QIG (Quick Installation Guide)

## Jumpers & Connectors

CN1, CN5: FAN Connector	
PIN NO.	Description
1	GND
2	+12V
3	NC

CN4: Voltage Connector	
PIN NO.	Description
1	+5V
2	-5V
3	-12V
4	+12V
5	GND

PCI ROUTING		
SIGNAL	PCI1	PCI2
REQ#	REQ0#	REQ1#
GNT#	GNT0#	GNT1#
CLOCK	CLK0	CLK1
IDSEL	AD19	AD20
INTA#	A	D
INTB#	B	A
INTC#	C	B
INTD#	D	C



### NOTE:

- a. Recommend to use 6mm width spacer to install

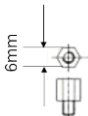

- b. Torsion must less than 6lb-inch

Get more information:



IP-3S



IIE Resource Download Center

Dimensions (Unit: mm)

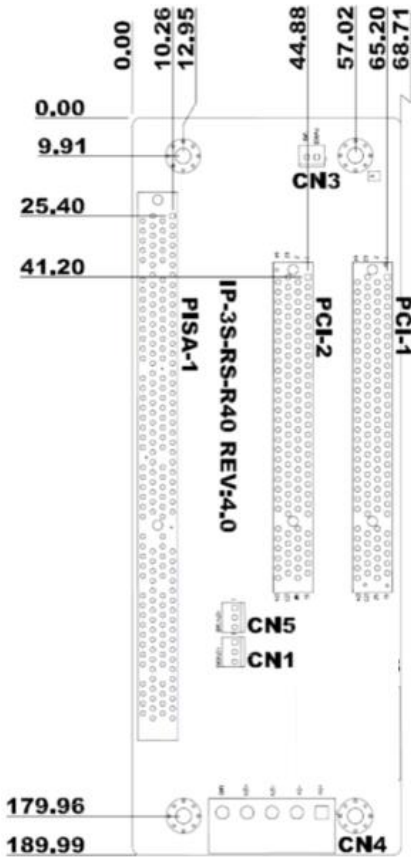

## Safety Instructions



Warning! Read the user manual before connecting the system to the power source.

Warning! To prevent the system from overheating, do not operate it in an area that exceeds the maximum operating temperature described in the user manual.

Warning! Ultimate disposal of this product should be handled according to all national laws and regulations.

## Support



### IEI Support URL

[http://new.ieiworld.com/tw/online\\_support\\_form](http://new.ieiworld.com/tw/online_support_form)

## Compliance



According to the requirement of the WEEE legislation the following user information is provided to customers for all branded IEI Electronics products subject to the WEEE directive.

This symbol on the product or on its packaging indicates that this product must not be disposed of with your other household waste. Instead, it is your responsibility to dispose of your waste equipment by handing it over to a designated collection point for the recycling of waste electrical and electronic equipment. The separate collection and recycling of your waste equipment at the time of disposal will help to conserve natural resources and ensure that it is recycled in a manner that protects human health and the environment. For more information about where you can drop o- your waste equipment for recycling, please contact your local city office, your household waste disposal service or the shop where you purchased the product.

### Headquarters

#### IEI Integration Corp.

No. 29, ZhongXing Rd., Xizhi Dist.,  
New Taipei City 221, Taiwan  
TEL: +886-2-8691-6798/+886-2-2690-2098  
FAX: +886-2-6616-0028  
sales@ieiworld.com  
www.ieiworld.com

### America

#### IEI Technology USA Corp.

138 University Parkway, Pomona,  
CA 91768, USA  
Tel:+1-909-595-2819  
Fax:+1-909-595-2816  
sales@usa.ieiworld.com  
usa.ieiworld.com

### China

#### IEI Integration (Shanghai) Corp.

No. 515, Shen Fu Rd., Xin Zhuang Industrial Develop Zone,  
Shanghai, 201108, China  
Tel:+86-21-3116-7799  
Fax:+86-21-3462-7797  
sales@ieiworld.com.cn  
www.ieiworld.com.cn