

**PCI Express Power-over-Ethernet Card,
2-port 2.5GbE, 802.3at Compliant, Low-profile, RoHS**

GPOE-2P2

Quick Installation Guide **Version 1.0**

February 20, 2023

Package List

GPOE-2P2 package includes the following items:

- 1 x GPOE-2P2 PCIe Power-over-Ethernet card
- 1 x Full height bracket
- 1 x QIG (Quick Installation Guide)



©2023 Copyright by IEI Integration Corp.
All rights reserved.

Specifications

- Interface: PCI Express® x1
- Ethernet:
Intel® I225 controllers
9kB jumbo frame
IEEE 802.3at, IEEE1588
- Power Input:
12 V ~ 24 V DC input
1 x Internal DC input connector (2x3 pin)
1 x External DC input jack (Φ 2.1/Φ 5.5)
CAUTION! Use one power input only at a time.
- PoE Capability:
IEEE 802.3at
30 W / 52 V DC per port (support a total of 60 watts at full load)
- Operating Temperature: 0°C ~ 60°C
- Storage Temperature: -10°C ~ 70°C
- Operating Humidity: 5% ~95%, non-condensing
- Dimensions: 130 mm x 65 mm
- Weight: 110g
- Safety: CE/FCC compliant

Ordering Information

- **GPOE-2P2-R10:**
PCI Express Power-over-Ethernet card, 2-port 2.5GbE, 802.3at compliant, low profile, and RoHS
- **32102-044900-100-RS:**
Power cable, 100mm, 20AWG, (A) two 4-pin MOLEX, p=5.08; (B) one 6-pin connector, p=4.2; RoHS
- **63040-010090-120-RS:**
Power adapter; FSP090-DIEBN2; Vin:90~264VAC; 90W;
cable=1500mm; Vout:19VDC; Φ 2.1/Φ 5.5/lock; CCL; RoHS
- **63040-010065-710-RS:**
Power adapter; FSP065-RBBN3; Vin:90~264VAC; 65W;
cable=1500mm; Vout:19VDC; Φ 2.1/Φ 5.5/lock; CCL; RoHS

Connector Pinouts

CN1: Internal power input connector (6-pin, p=4.2 mm)					
Pin	Description	Pin	Description		
1	Power in	4	GND		
2	Power in	5	GND		
3	Power in	6	GND		

J1: External power input connector (DC jack)					
Pin	Description	Pin	Description		
1	Power in	3	GND		
2	GND				

PLAN3: External RJ-45 2.5GbE connectors					
Pin	Description	Pin	Description		
1	P0	5	N2		
2	N0	6	N1		
3	P1	7	P3		
4	P2	8	N3		
LED	Description	LED	Description		
A	Off: 100 Mb/s Green: 2.5 Gb/s Orange: 1 Gb/s	B	On: linked Blinking: data is being sent/received		

All the drivers and utility for the GPOE-2P2 are available on IEI Resource Download Center. Type GPOE-2P2 and press Enter to find all the relevant software, utilities, and documentation. To install software from the downloaded ISO file, mount the file as a virtual drive to view its content.

IEI Resource Download Center

<https://download.ieiworld.com>



LED Indicators

When installing multiple GPOE-2P2 cards in one system, the ID of each card is indicated by the two LED indicators on the I/O panel as described below.

LED	Card ID	LED	Card ID
● Red	Card 1	● Red	Card 5
● Red		○ Off	
● Red	Card 2	○ Off	Card 6
● Green		● Green	
● Green	Card 3	○ Off	Card 7
● Red		● Red	
● Green	Card 4	● Green	Card 8
● Green		○ Off	

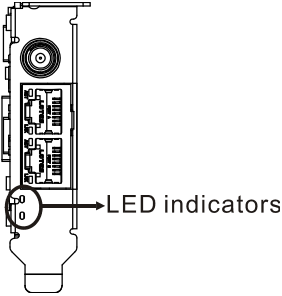

Board Layout & Connector Locations

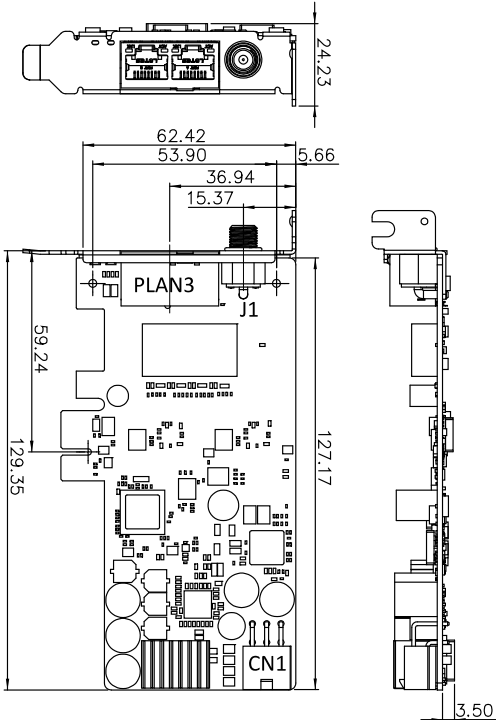

(Unit: mm)