

**DisplayPort Expansion Board
(for IEI Display Module Slot)
RoHS**

iDPM-DP-R10
Quick Installation Guide
Version 1.0

February 14, 2023

Package Contents

iDPM-DP package includes the following items:

- 1 x iDPM-DP expansion board
- 1 x QIG (Quick Installation Guide)



©2023 Copyright by IEI Integration Corp.
All rights reserved.

Features:

- DisplayPort output
- Small and light, easy to install

Specifications:

- **Form Factor:**
M.2 2240/3040 B key
- **Internal Connector:**
1 x DisplayPort connector
- **Compatible OS:**
Windows XP/Server 2003/ Server 2008/ Vista/ 7 /8.1/10
Linux kernel version 2.6.32 or latter
- **Operating Temperature:**
0°C ~ 60°C
- **Operating Humidity:**
5% ~ 95%, non-condensing
- **Dimensions (LxW):**
40 mm x 22 mm

Ordering Information

- **iDPM-DP-R10:** DisplayPort expansion board (for IEI Display Module Slot), RoHS

Connector Pinouts

DP1 : DisplayPort Connector			
PIN NO.	DESCRIPTION	PIN NO.	DESCRIPTION
1	DPB_0P	11	GND
2	GND	12	DPB_3N
3	DPB_0N	13	GND
4	DPB_1P	14	GND
5	GND	15	DP_AUX_CTRL_P2
6	DPB_1N	16	GND
7	DPB_2P	17	DP_AUX_CTRL_N2
8	GND	18	DPB_HPD
9	DPB_2N	19	GND
10	DPB_3P	20	+3.3V

Board Layout and Connector Location

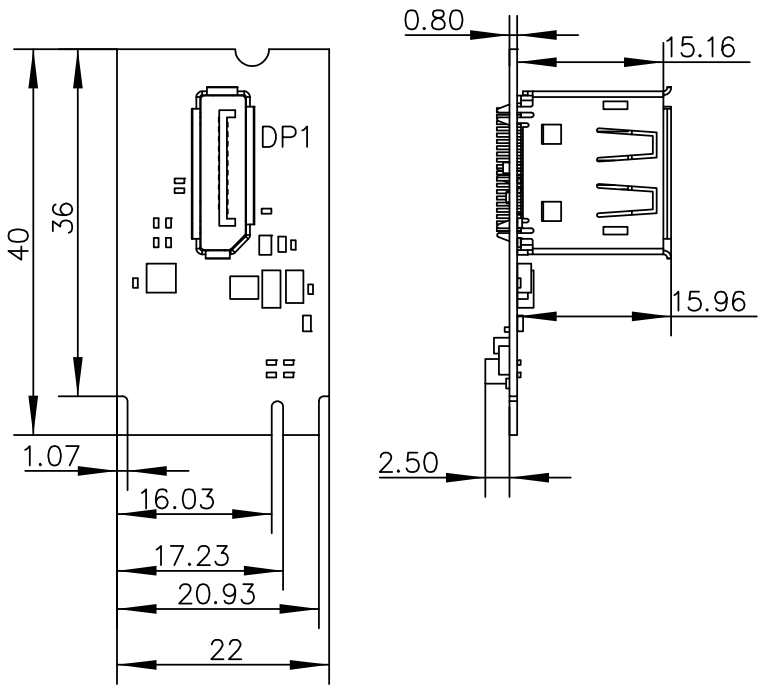

(Unit: mm)