

IPX-13S-RS-R40

13-Slot Backplane with 12 PCI Bus

User Manual Ver. 4.0

1. PW2: ATX Power Connector

Pin	Description	Pin	Description
1	+3.3Vdc	11	+3.3Vdc
2	+3.3Vdc	12	-12Vdc
3	GND	13	GND
4	+5Vdc	14	PS-ON
5	GND	15	GND
6	+5Vdc	16	GND
7	GND	17	GND
8	PWR-OK	18	-5Vdc
9	+5VSB	19	+5Vdc
10	+12Vdc	20	+5Vdc

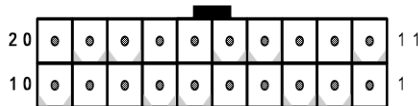

2. PW1: AT Power Connector

Pin	Description	Pin	Description
1	PWRGD	7	GND
2	+5V	8	GND
3	+12V	9	-5V
4	-12V	10	+5V
5	GND	11	+5V
6	GND	12	+5V

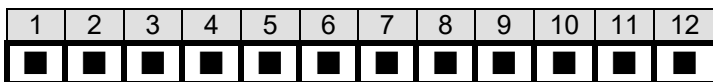

3. CN2: Backplane to Mainboard ATX power control connector

Pin	Description
1	GND
2	PSON#
3	5VSB



4. CN3, CN5: Fan Connector

Pin	Description
1	GND
2	+12V
3	NC



5. CN1: Voltage Connector

Pin	Description
1	+5V
2	-5V
3	-12V
4	+12V
5	GND

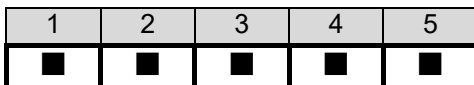

6. CN7: Voltage Connector

Pin	Description
1	+3.3V
2	GND

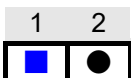

7. CN6, CN8: Power Connector

Pin	Description
1	+5V
2	+5V
3	+5V
4	GND
5	GND
6	GND

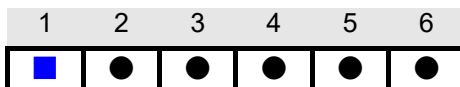

8. PCI routing table:

PCI Routing					
Sginal	REQ#	GNT#	CLOCK	IDSEL	INT
PCI 1	REQ0#	GNT0#	CLK0	AD19	A, B, C, D
PCI 2	REQ1#	GNT1#	CLK1	AD20	D, A, B, C
PCI 3	REQ3#	GNT3#	CLK3	AD22	B, C, D, A

PCI Routing					
Sginal	REQ#	GNT#	CLOCK	IDSEL	INT
PCI 4	REQ0#	GNT0#	CLK0	AD20	C, D, A, B
PCI 5	REQ1#	GNT1#	CLK1	AD21	D, A, B, C
PCI 6	REQ2#	GNT2#	CLK2	AD22	A, B, C, D
PCI 7	REQ3#	GNT3#	CLK3	AD23	B, C, D, A
PCI 8	REQ4#	GNT4#	CLK4	AD24	C, D, A, B
PCI 9	REQ5#	GNT5#	CLK5	AD25	D, A, B, C
PCI 10	REQ6#	GNT6#	CLK6	AD26	A, B, C, D
PCI 11	REQ7#	GNT7#	CLK7	AD27	B, C, D, A
PCI 12	REQ8#	GNT8#	CLK8	AD28	C, D, A, B

9. Notice:

Recommend to use 6mm width spacer to install

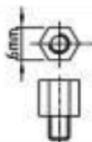

b. Torsion must less than 6lb-inch

10. Dimension:

