



# **ideaPairingX**

**(App for Pairing with Wi-Fi)**

## **User Manual**

**Rev. 1.01 - December 3, 2024**



# Revision

Date	Version	Changes
December 3, 2024	1.01	Clarified and refined the descriptions in Chapter 2 for better readability and understanding.
February 21, 2024	1.00	Initial release



# Copyright

---

## **COPYRIGHT NOTICE**

The information in this document is subject to change without prior notice in order to improve reliability, design and function and does not represent a commitment on the part of the manufacturer.

In no event will the manufacturer be liable for direct, indirect, special, incidental, or consequential damages arising out of the use or inability to use the product or documentation, even if advised of the possibility of such damages.

This document contains proprietary information protected by copyright. All rights are reserved. No part of this manual may be reproduced by any mechanical, electronic, or other means in any form without prior written permission of the manufacturer.

## **TRADEMARKS**

All registered trademarks and product names mentioned herein are used for identification purposes only and may be trademarks and/or registered trademarks of their respective owners.



# Table of Contents

---

<b>1 OVERVIEW .....</b>	<b>1</b>
1.1 OVERVIEW.....	2
1.2 SYSTEM REQUIREMENTS .....	2
1.3 INSTALLING IDEAPAIRINGX .....	2
<b>2 USING IDEAPAIRINGX.....</b>	<b>6</b>
2.1 PAIRING EPAPER DEVICE – ONLINE MODE.....	7
2.2 PAIRING EPAPER DEVICE – OFFLINE MODE .....	13
2.3 TROUBLESHOOTING .....	21

Chapter

1

# Overview

---

## 1.1 Overview

The **ideaPairingX** is a mobile application designed to make the Wi-Fi commissioning process easy for IEI ePaper devices. With the **ideaPairingX**, users can pair your IEI ePaper devices with Wi-Fi access point (AP) and log into the IRM.

IEI's ePaper devices come with a convenient built-in Wi-Fi connection function, making it easy to connect and configure the device to your network. By using the **ideaPairingX** app and connecting the ePaper device to your mobile phone via Bluetooth, you can seamlessly pair the device with the network. During the pairing process, you'll be prompted to provide the SSID and password of the Wi-Fi access point, as well as the IP address and IP port of the iRM. This streamlined Wi-Fi commissioning process is especially useful for IT staff when deploying a large number of devices, saving time and effort.

## 1.2 System Requirements

The mobile phone requirement for installing the **ideaPairingX** is as following:

- OS: Android 10 or latter

## 1.3 Installing ideaPairingX

**Step 1:** Save the **ideaPairingX\_v1.0.xxxxx.apk** ("xxxxx" denotes the version of the application) file to your computer.

**Step 2:** Connect your Android mobile phone to the computer using a USB cable, and move the APK file to the "Downloads" folder on your mobile phone.

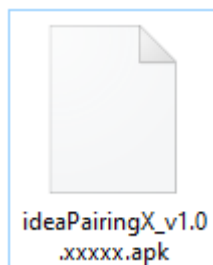

**Step 3:** In your mobile phone, go to **Files** → **Downloads**. Tap the APK file.

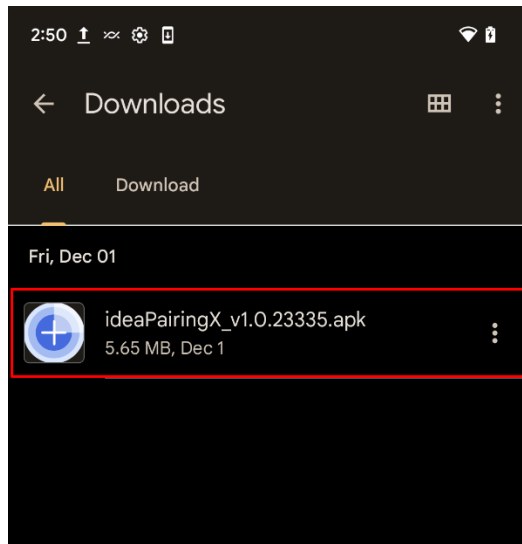

**Step 4:** When prompted with the following message, tap **Install**.

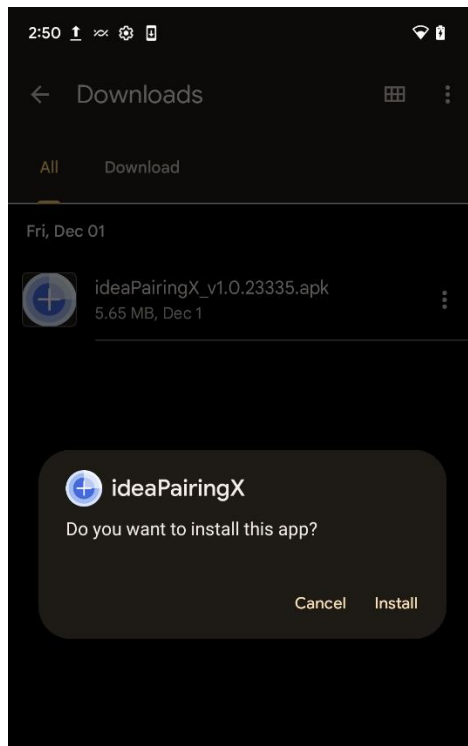





**Step 5:** When installation completes, you can find the **ideaPairingX** in the app drawer. Tap the icon to launch it.

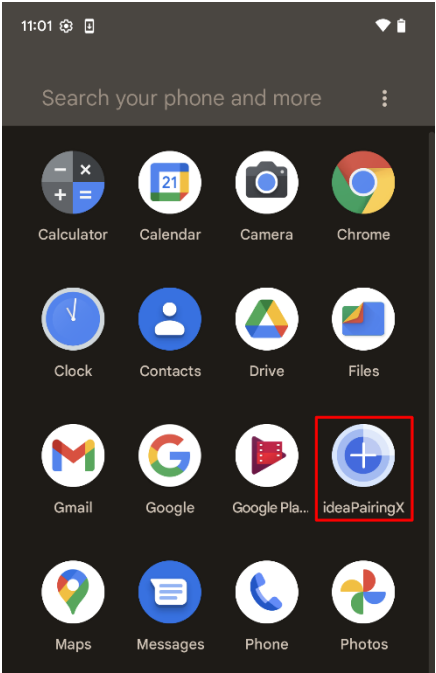



**Step 6:** When you open the app for the first time, you will see the following messages. Be sure to allow the **ideaPairingX** to access the device location and to find nearby devices.

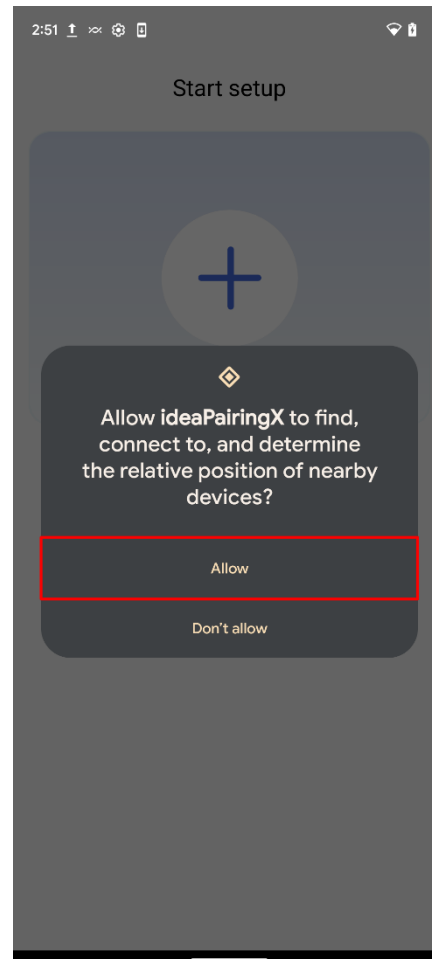
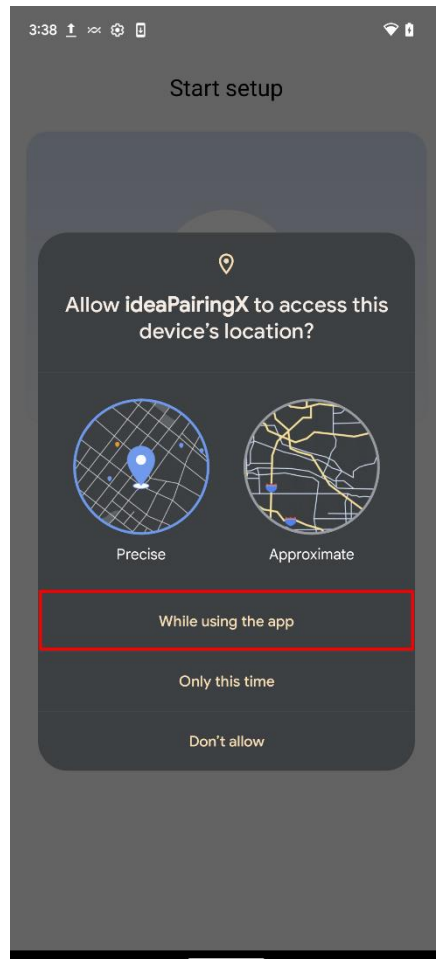

Chapter

**2**

# Using ideaPairingX

---

**WARNING:**

The **ideaPairingX** communicates with the e-paper device using its **Wi-Fi mode**. However, activating Wi-Fi mode will delete all data previously saved via the **ditherPrint application (UART mode)**.

**Key Points to Remember:**

- Switching between **Wi-Fi mode** and **UART mode** erases any data saved in the alternate mode.
- This ensures a clean storage environment for optimal e-paper device performance.

**Tip:** Plan your usage to avoid accidental data loss during mode changes.

## 2.1 Pairing ePaper Device – Online Mode

**Step 1:** Press the Bluetooth button on the rear panel of the IEI ePaper device. **Note:** the ePaper device must be provided with battery or USB power.





**Step 2:** The following screen shows, and the blue LED on the front panel starts flashing.



**Step 3:** On the mobile phone, tap the icon of the **ideaPairingX** application to launch it.

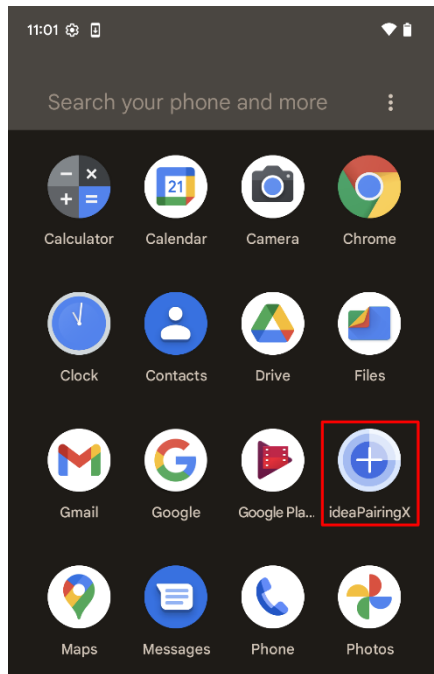

**Step 4:** Before starting pairing with the Wi-Fi, make sure you meet the following criteria:

- The mobile phone must get close to the ePaper device
- Turn on Bluetooth and Wi-Fi connection of the mobile phone
- Allow access to the mobile phone's location

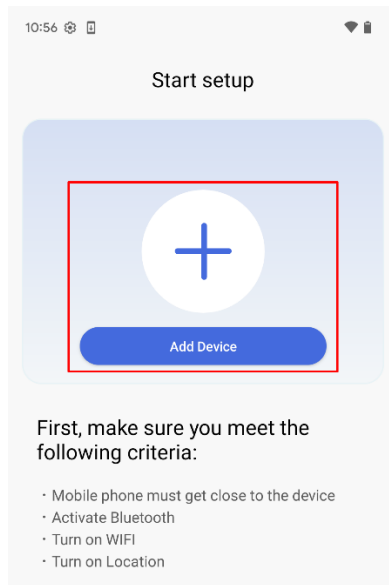
**Step 5: Tap Add Device**

**Step 6:** The **ideaPairingX** shows a list of nearby ePaper device. Identify the ePaper device using the UID number (MAC address). Tap one or multiple devices to start pairing with the network. Up to 7 devices can be selected each time. Click **Next** to continue.

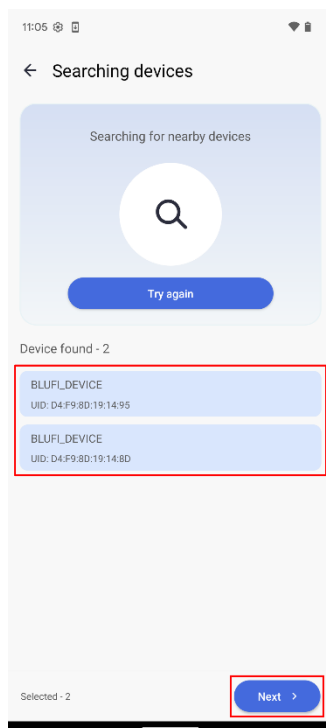



**Step 7:** The following screen appears, click **Next** to continue.

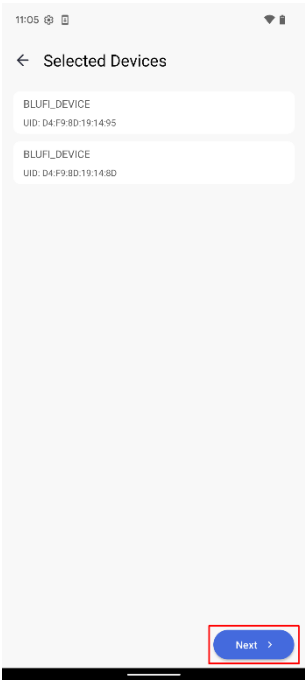

**Step 8:** A list of Wi-Fi AP shows. Choose the Wi-Fi AP that the computer, which is currently connected to the IRM, is using. Click **Next**.

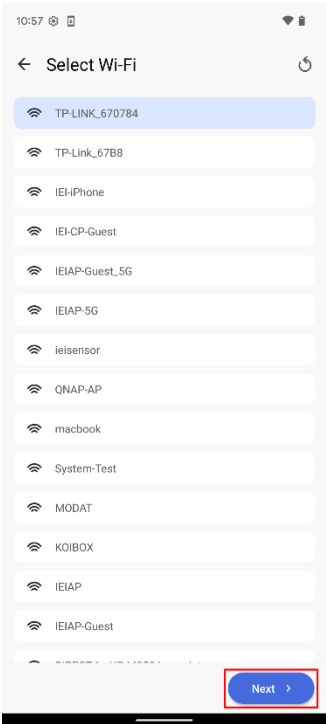



**Step 9:** Configure the device settings.

1. Enter the password of the selected Wi-Fi AP.
2. Enter the IP address of the IRM.
3. Configure the MQTT port: 1883 (unencrypted) or 8883 (encrypted)
4. Optional: give a brief description of the ePaper device; it will be shown in the “Note” column on the Electronic Paper Device page of the IRM
5. Optional: Check “Set as default value” to save the settings as default

10:58

× Device Settings

Wi-Fi

Wi-Fi Name  
TP-LINK\_670784

1 Wi-Fi Password  0/63

Device

2 IRM IP

3 MQTT Port  
8883

4 Note  
0/256

Set as default value ☐ 5

Confirm >

**Step 10:** Tap **Confirm** to continue

**Step 11:** When prompted with the following message, select **Online mode** as the connection mode.



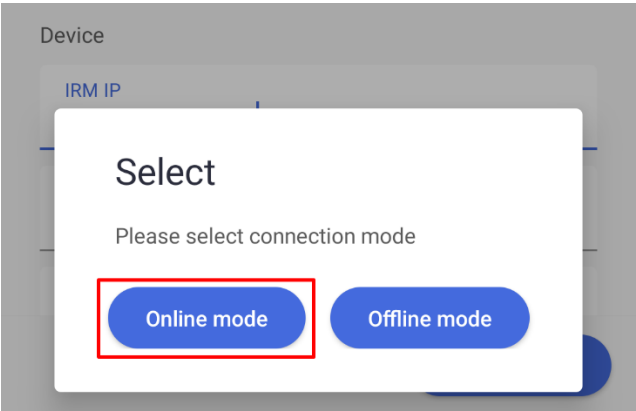

**Step 12:** The ePaper flashes the screen, and the following screen shows with the successful message indicated by the blue check marks for both Wi-Fi and MQTT.

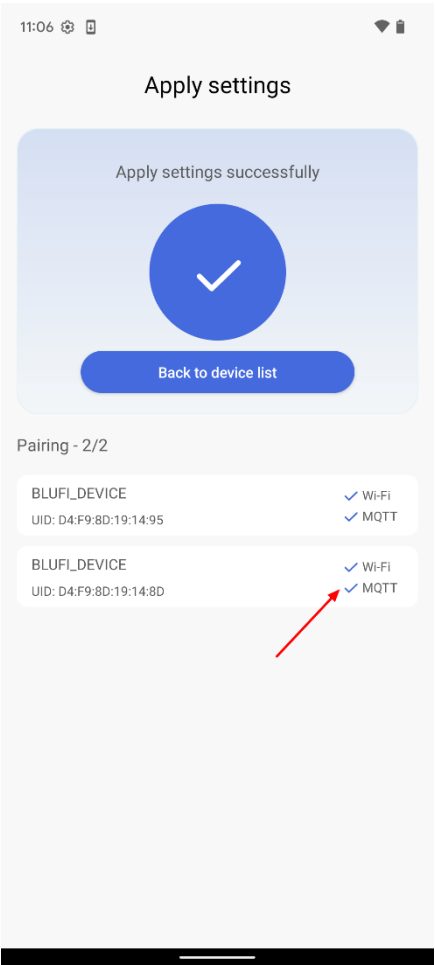

**Step 13:** The ePaper successfully connects to the IRM, which can be identified by checking the MAC address.

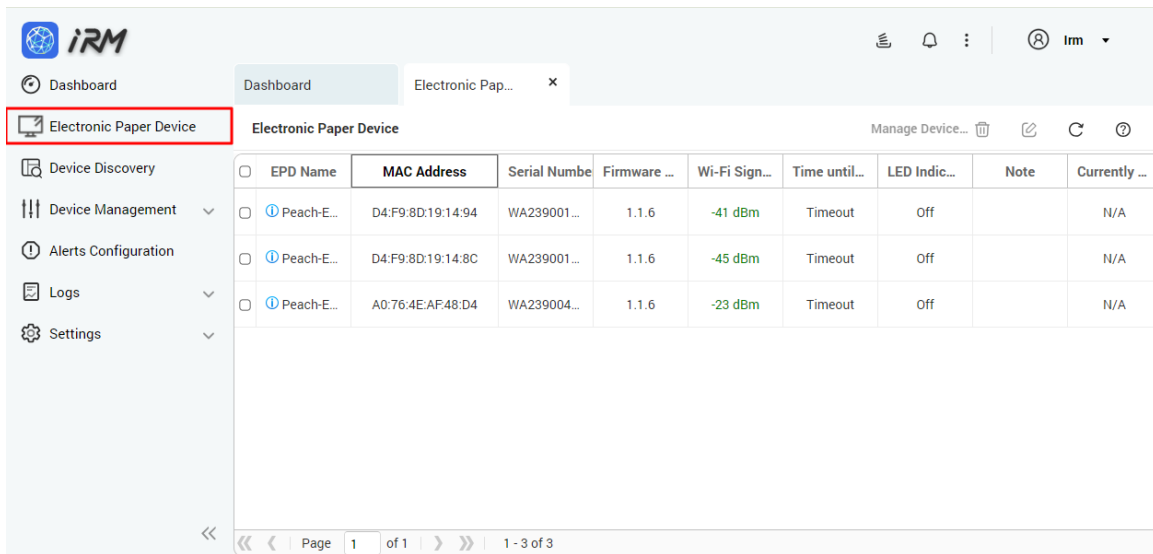

The screenshot shows the iRM dashboard with the 'Electronic Paper Device' menu item highlighted. The main content area displays a table of connected devices. The table has columns for EPD Name, MAC Address, Serial Number, Firmware, Wi-Fi Signal, Time until, LED Indicator, Note, and Current Status. Three devices are listed, all with a status of 'N/A'.

EPD Name	MAC Address	Serial Number	Firmware	Wi-Fi Signal	Time until	LED Indicator	Note	Current Status
Peach-E...	D4:F9:8D:19:14:94	WA239001...	1.1.6	-41 dBm	Timeout	Off		N/A
Peach-E...	D4:F9:8D:19:14:8C	WA239001...	1.1.6	-45 dBm	Timeout	Off		N/A
Peach-E...	A0:76:4E:AF:48:D4	WA239004...	1.1.6	-23 dBm	Timeout	Off		N/A

**Step 14:** After the ePaper device connects to the IRM, the **ideaPairingX** will disconnect the ePaper. Then the user can pair other devices with the network.

## 2.2 Pairing ePaper Device – Offline Mode

The **ideaPairingX** allows users to save the network information into the ePaper device by using the offline mode. IT personnel can greatly benefit from this function when they need to prepare a large number of ePaper devices at their office in advance. This not only saves time and effort but also allows for efficient management and deployment of the devices. To do this, follow the steps below:



**Step 1:** Press the Bluetooth button on the rear panel of the IEI ePaper device. **Note: the ePaper device must be provided with battery or USB power.**



**Step 2:** The following screen shows, and the blue LED on the front panel starts flashing.



**Step 3:** Turn off the Wi-Fi connection on the mobile phone. **Note:** In the offline mode, the **ideaPairingX** transfers information to the ePaper device through Bluetooth.

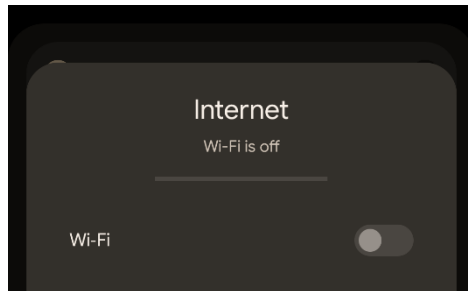

**Step 4:** On the mobile phone, tap the icon of the **ideaPairingX** application to launch it.

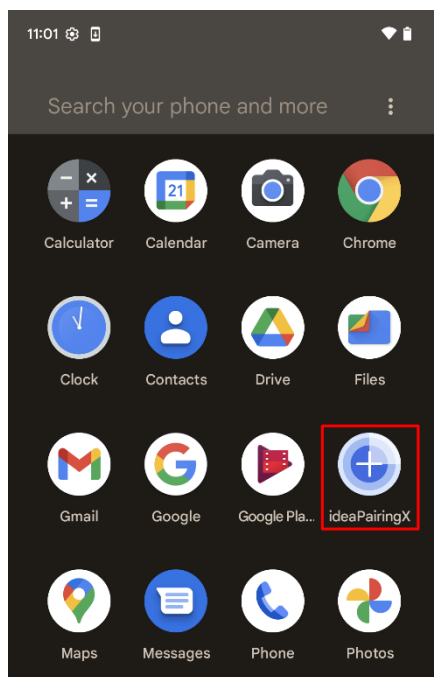

**Step 5:** An alert message appears. Tap **Confirm** to continue.

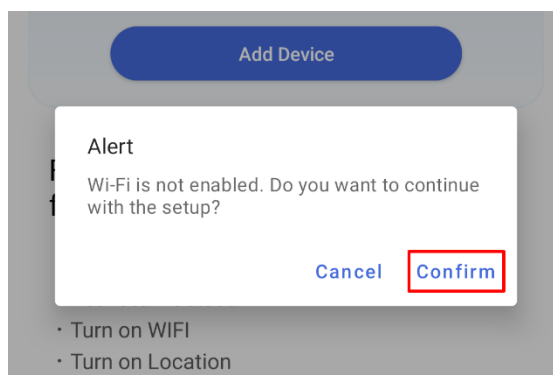



**Step 6:** Tap **Add Device**

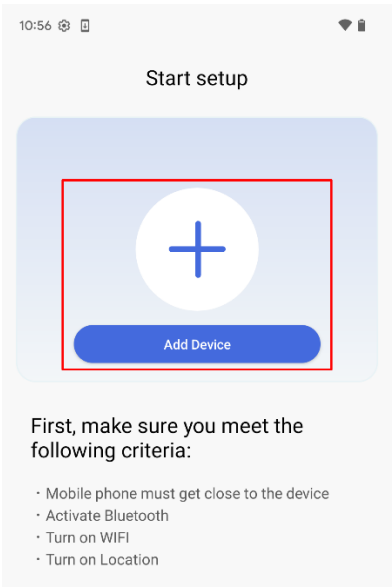

**Step 7:** The **ideaPairingX** shows a list of nearby ePaper device. Identify the ePaper device using the UID number (MAC address). Tap one or multiple devices to start pairing with the network. Up to 7 devices can be selected each time. Click **Next** to continue.

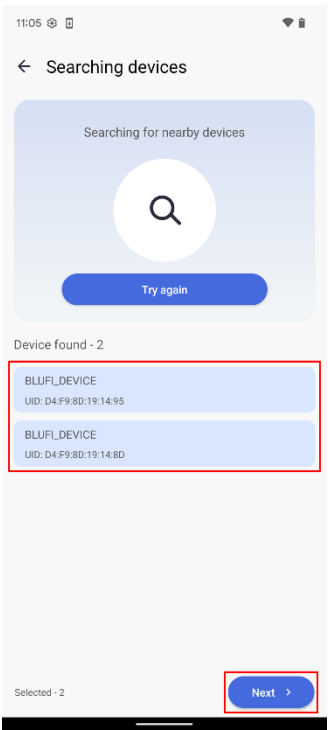

**Step 8:** The following screen appears, click **Next** to continue.

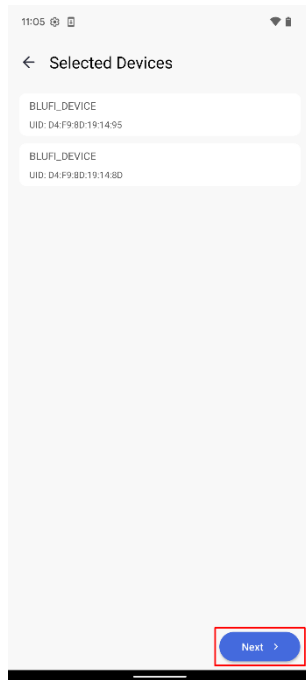

**Step 9:** A list of Wi-Fi AP shows. Scroll down until you see the **+Add** button. Tap **+Add** to add a Wi-Fi AP manually.

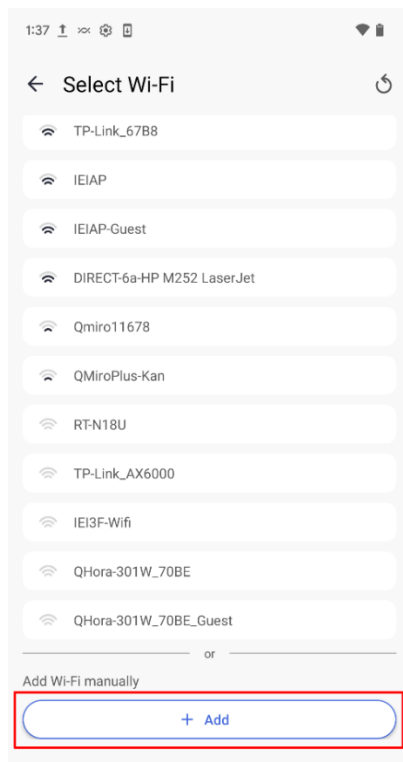





**Step 10:** In the following screen, enter the name and password of the Wi-Fi AP. Tap **Save** to save the settings.

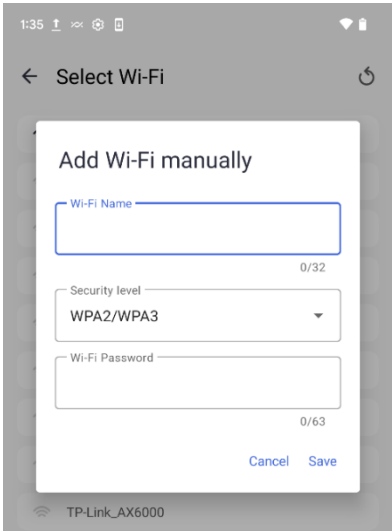

**Step 11:** Tap the Wi-Fi AP you just created. Click **Next**.

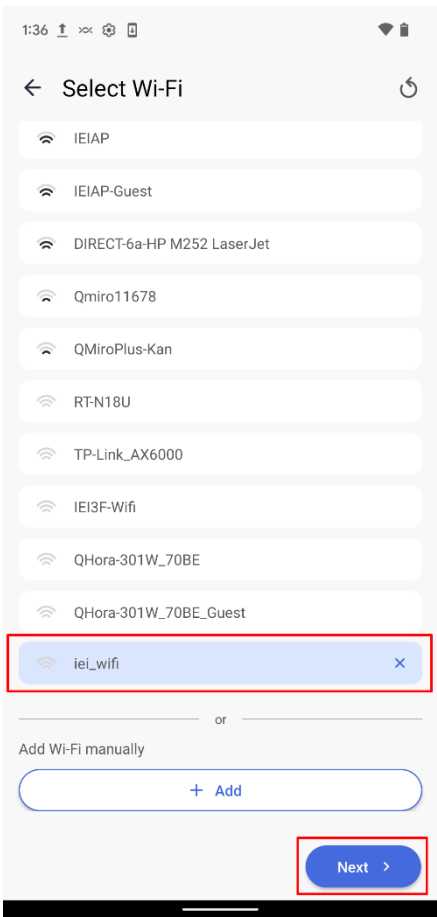



**Step 12:** Configure the device settings.

1. Enter the password of the selected Wi-Fi AP.
2. Enter the IP address of the IRM.
3. Configure the MQTT port: 1883 (unencrypted) or 8883 (encrypted)
4. Optional: give a brief description of the ePaper device
5. Optional: Check “Set as default value” to save the settings as default

10:58

× Device Settings

Wi-Fi

Wi-Fi Name  
TP-LINK\_670784

1 Wi-Fi Password   
0/63

Device

2 IRM IP

3 MQTT Port  
8883

4 Note  
0/256

Set as default value ☐ 5

Confirm >

**Step 13:** Tap **Confirm** to continue



**Step 14:** When prompted with the following message, select **Offline mode** as the connection mode.

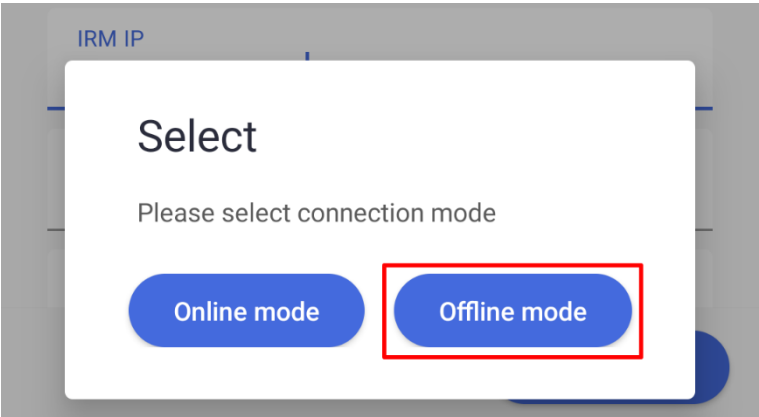

**Step 15:** The ePaper flashes the screen, and the following screen shows with the successful message.

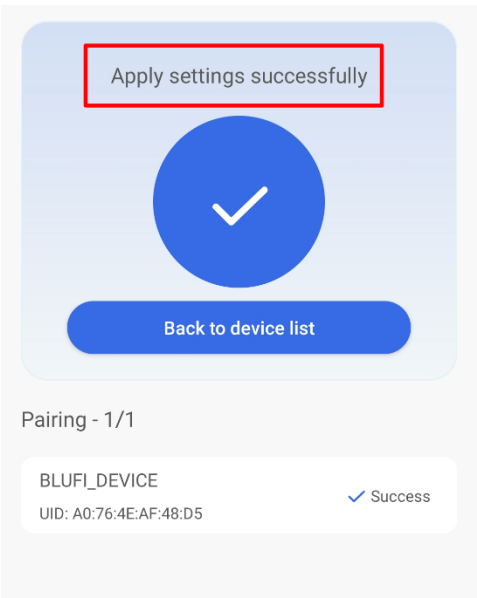

## 2.3 Troubleshooting

If the ePaper device fails to pair with the network, the **ideaPairingX** app can help you locate it.

### Identification Methods:

1. **Scan the QR Code:**
  - Use the app to scan the QR code on the front panel of the ePaper device.
2. **Activate the LED Indicator:**
  - Turn on the device's LED indicator for easier identification.

Follow the on-screen steps in the app to complete the process.

**Step 1:** The following screen will show when the **ideaPairingX** fails to pair the ePaper with the network. Tap the 3-dot icon to bring up more functions.

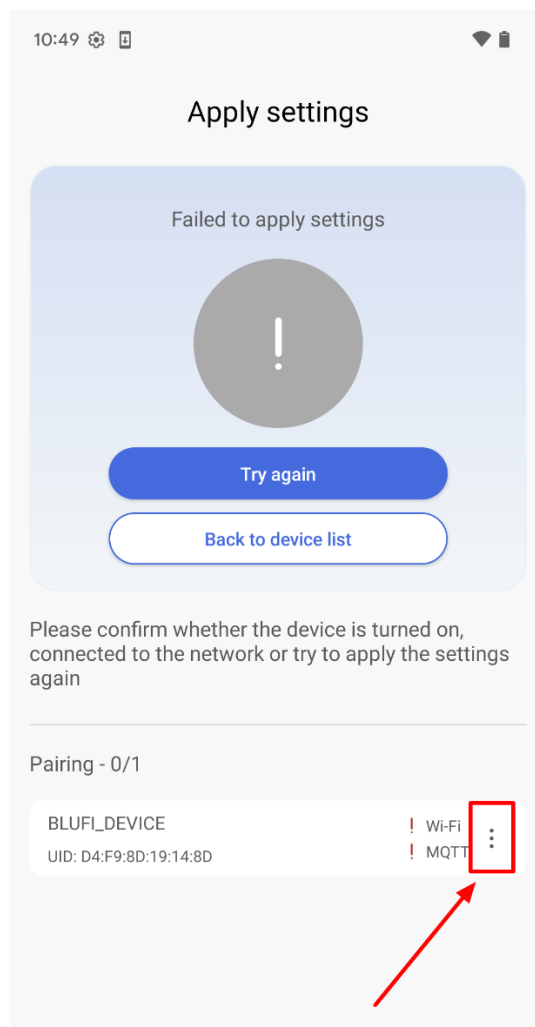



**Step 2:** The option menu appears at the bottom of the screen.

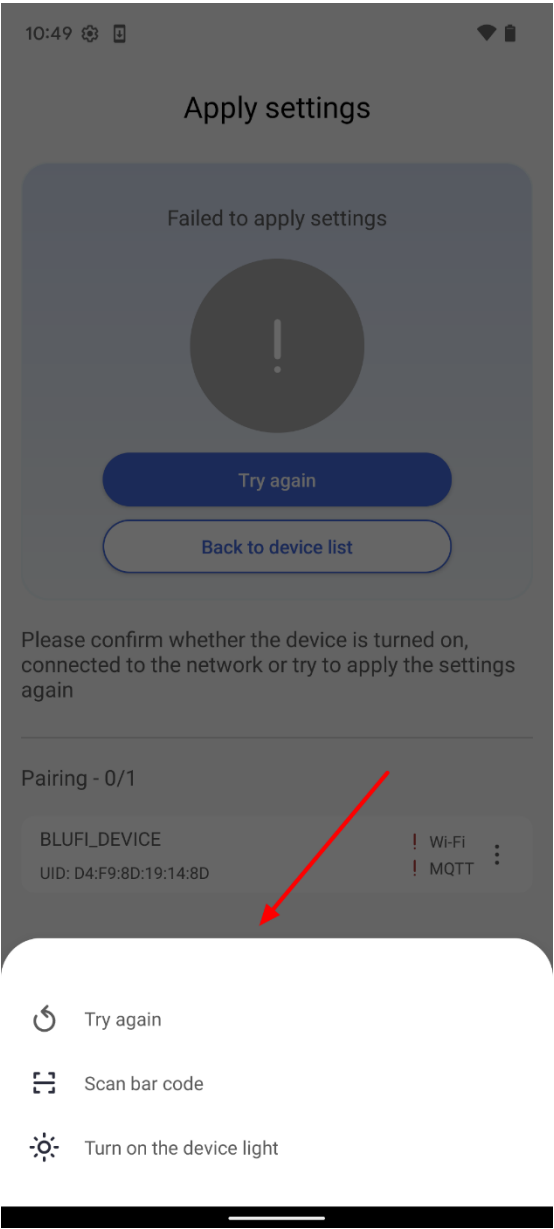

**Step 3:** a) Tap **Scan bar code**.

1. **Launch the Camera App:** The mobile phone will automatically open the camera app.
2. **Scan the QR Code:** Use the camera to scan the QR code located on the upper right corner of the ePaper's front panel.
3. **MAC Address and Device ID Matching:** The QR code contains a unique MAC address, which the app compares with the device ID obtained via Bluetooth.
4. **Confirmation:** If the MAC address matches the device ID, a confirmation message will appear.

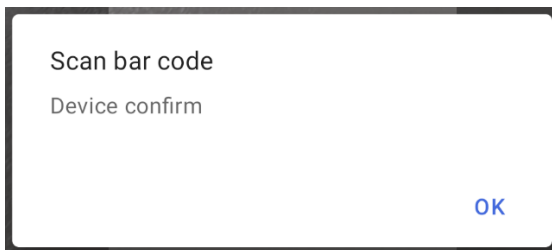
b) Tap **Turn on the device light**.

The LED indicator of that ePaper device will light on for you to identify.