



AXON-mPOWER

3-Slot Hot Swappable Batteries
Medical Online DC UPS System



Three Hot-Swappable Batteries Medical DC UPS System

The IEI AXON-mPOWER is a revolutionary medical-grade power solution designed to keep your critical equipment running smoothly and securely. Featuring a compact and scalable design with three hot-swappable 9000mAh lithium-ion battery packs, this system ensures continuous operation in both UPS (Uninterruptible Power Supply) and portable Power Bank modes. Whether mounted on a medical cart or integrated into a larger system, AXON-mPOWER offers versatile installation options with VESA 100 compatibility.

Three hot-swappable 9000mAh lithium-ion battery packs (TC-202GA)

- 3S3P Li-ion battery pack, 10.8V, 9000mAh, delivers reliable and long-lasting power.
- Battery status indicators (4 steps: 25%/50%/75%/100%)

Local Battery Management

Configures the battery percentage thresholds for both entering sleep mode and system shutdown to prevent data loss.

Remote UPS SNMP Management

Manage multiple UPS systems and perform various management tasks.

Dual Configurable DC Outputs

- Indicators show the status of each DC output voltage
- DC out 1 : 12V/15V/19V/24V (max: 100W)
- DC out 2 : 12V/15V/19V/24V (max: 100W)

* DC out 1 + DC out 2 ≤ 125W

Desktop and VESA 100 Mountable

Offers versatile installation options, allowing for easy setup in any workspace or environment.

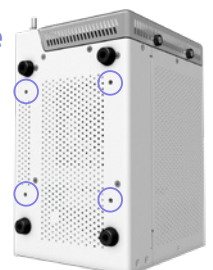

Two-in-One System

IEI AXON-mPOWER can be a UPS (uninterruptible power supply) system or a portable battery power bank, ensuring that your system is always ready when you need it.

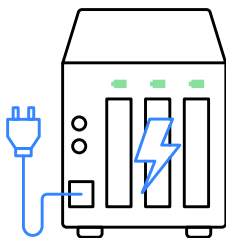

Online DC UPS mode

offers zero transfer time, protecting critical medical equipment and network systems from damage, downtime, and data loss.

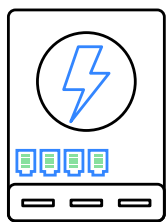

Power Bank mode

uses battery power to start without AC input for mobility and portability applications.

Optional Accessories

POCm-DOCKING-6BAY

Stackable 6-bay charging station

- Battery docking station with fast charging which takes Battery docking station with fast charging, from 0% to 100% in under 3.5 hours.
- Support up to 6 pcs TC-202GA battery packs.



31603-000106-RS

9000 mAh 97 Wh Battery Pack, with a nominal voltage of 10.8V. It supports a maximum charge current of 4A and a maximum discharge current of 5A

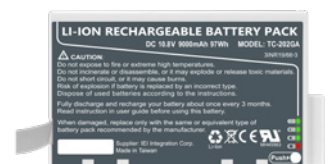

Both UPS and Power Bank in One

IEI AXON-mPOWER can be a UPS (uninterruptible power supply) system or a portable battery power bank, ensuring that your system is always ready when you need it.

Mode A: Online DC UPS System

IEI's medical-grade UPS (uninterruptible power supply) system, AXON-mPOWER, is engineered to protect and power critical and sensitive equipment in healthcare facilities, networking, and factory automation. With its zero transfer time DC UPS feature, it ensures an uninterrupted power supply, eliminating downtime and safeguarding essential equipment to ensure the highest system availability.

• Normal Operation:

When the input power is normal, the UPS stabilizes the voltage and supplies it to the load while charging the internal battery. In the event of a power outage or other interruption, the UPS immediately switches to the internal battery, which is converted to DC power and supplied to the load.

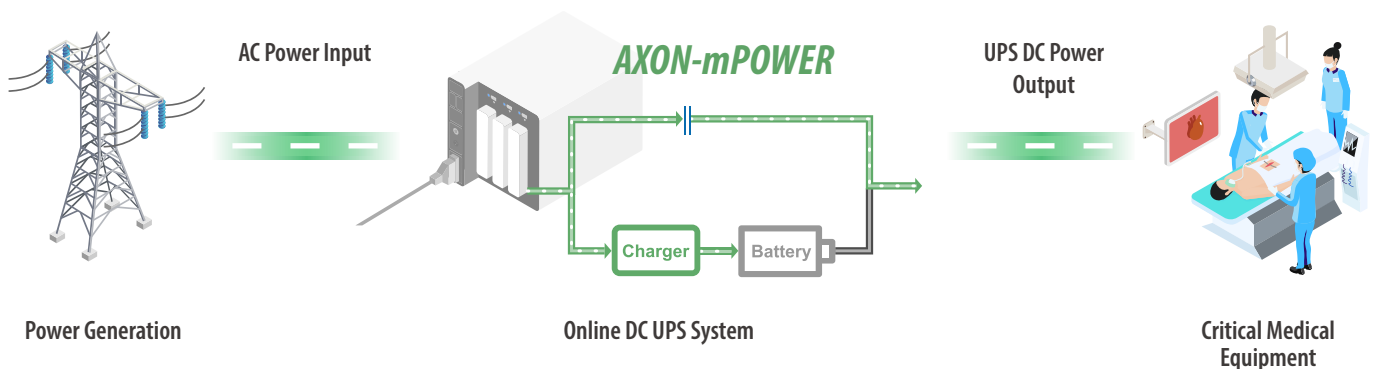

• When there is a loss, or a significant reduction, in the primary power source:

When an AC outage occurs, the online UPS system does not have a transfer time, because the UPS system is already supplying the connected equipment load when an outage occurs.

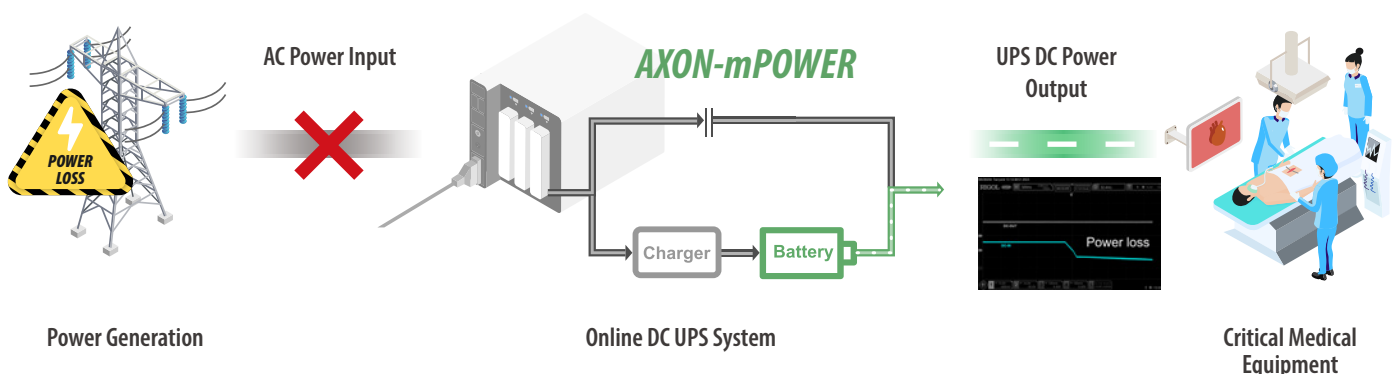

Where Can It Be Used?

● Reliable Backup Power for Medical Equipment

Medical uninterruptible power supply is most commonly used in imaging equipment, diagnostic equipment, and instruments. Our medical grade UPS system, AXON-mPOWER, can provide consistent backup power for the most sensitive medical equipment in hospitals and medical facilities. When the battery is depleted, the POCm-DOCKING-6BAY can be used for regular battery pack preparation.

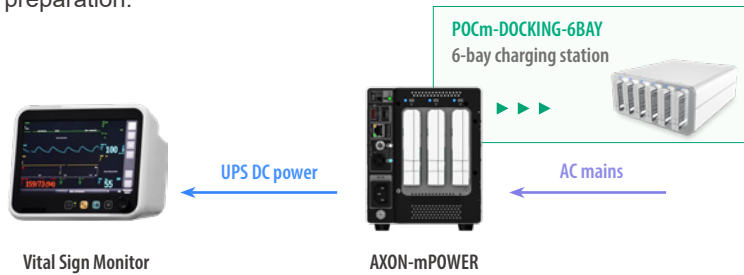

● UPS for NAS with SNMP Remote Management

A UPS with SNMP remote management ensures continuous NAS operation during power interruptions and allows real-time monitoring and automated safe shutdowns, enhancing data protection and minimizing downtime.

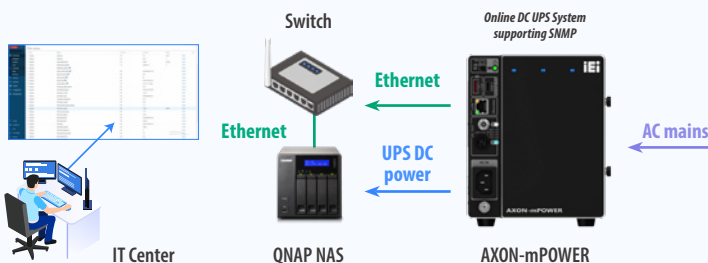

● UPS Secures 24/7 Manufacturing Operations

The manufacturing plant, operating 24/7 to meet global demand, experienced frequent power fluctuations and occasional outages. IEI's AXON-mPOWER high-capacity UPS units were tailored to the plant's specific needs.

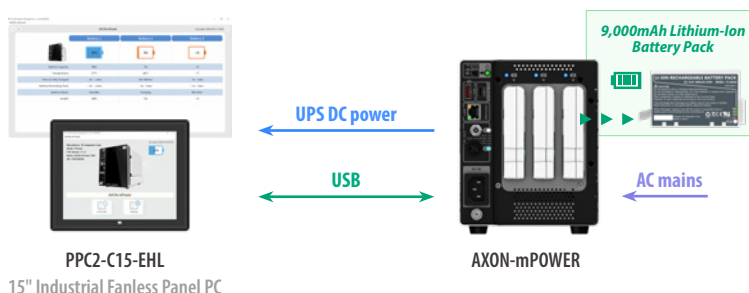

Why do We Need the UPS Monitoring?

When devices operate on battery power from an uninterruptible power supply (UPS) during a power outage, if the outage lasts for an extended period, the battery may run out, causing the AXON-mPower UPS to shut down along with the connected devices. This shutdown can result in data loss or device damage. To prevent this, IEI AXON-mPower provides two methods to constantly monitor the performance of the UPS, either locally or over the network using SNMP.

Local Monitoring by USB:

The AXON-mPower UPS parameters can be monitored locally via USB by simply connecting the UPS to a computer using a cable. You can monitor and customize settings through the AXON-mPower UPS utility. All the basic parameters will be available for monitoring, such as battery temperature, battery capacity, time to full charge, remaining runtime, etc.

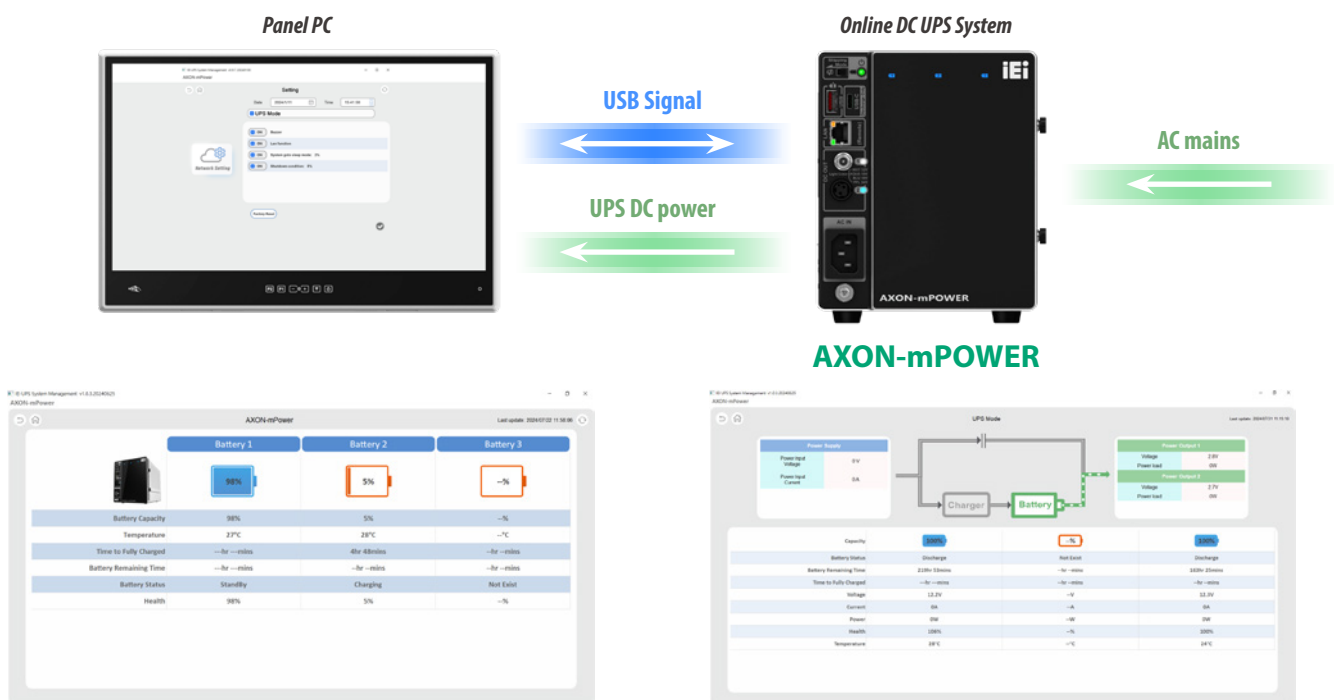

Remote Monitoring by SNMP:

When the NAS system and the AXON-mPower UPS are connected to the same network, you can monitor and manage the UPS remotely using SNMP, allowing you to ensure the UPS system's performance and respond quickly to any issues.

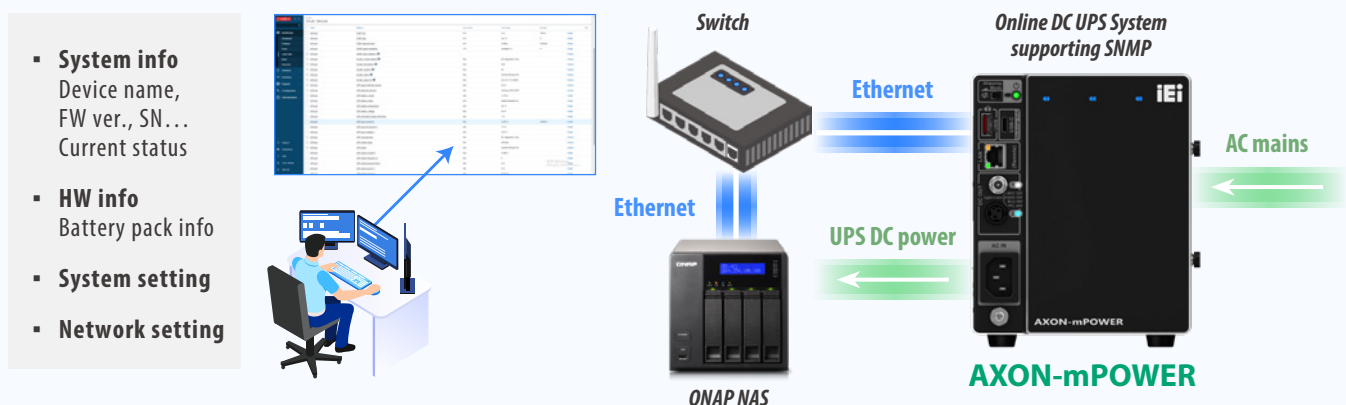

Mode B: Power Bank System

Revolutionizing Healthcare Mobility with Superior Performance

The healthcare landscape demands seamless mobility, and IEI's AXON-mPOWER series with its hot-swappable battery delivers just that. These cost-friendly, lightweight medical carts offer unparalleled mobility, allowing healthcare providers to charge peripherals on the move without limits.



• Cost-Friendly Mobile Cart Power Solution

The AXON-mPOWER is the most cost-effective solution for mobile cart power management, offering exceptional efficiency and reliability at an affordable price.

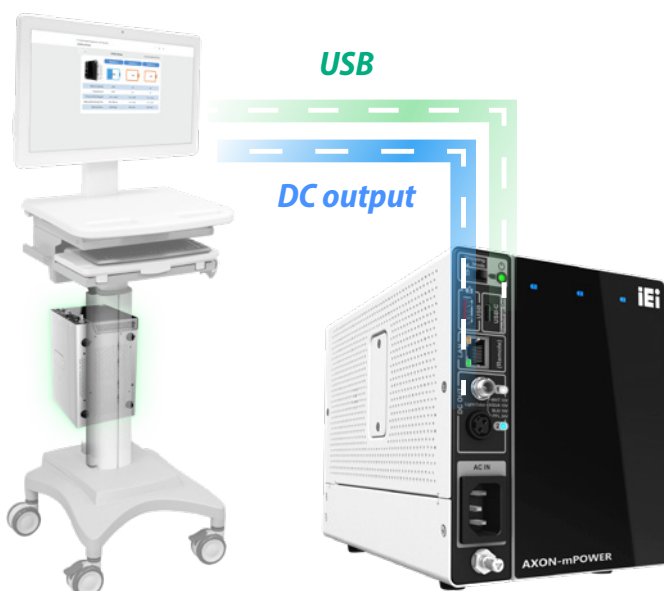
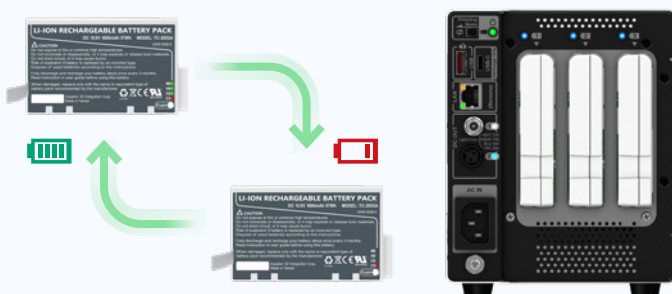

• Local Battery Monitoring

A local battery monitoring utility enhances efficiency, reliability, and longevity of battery use by providing real-time insights, and preventive alerts, ensuring devices operate optimally around the clock.



Windows



Linux API

Hot Swappable, Non Stoppable

Swap out batteries with fully charged ones on-the-fly to ensure you never lose power to your gear. The Battery Bank will cycle through each battery one at a time keeping the power running. Run for hours or days without stopping.

• High Power-Intensive Loading (105W-125W)

User scenario	$105W < DC1 + DC2 + USB-C < 125W$
Minimum battery pack required	3
Battery charging behavior	Connected system to a power source for charging
24 / 7 support	System downtime needed for battery charging

"Three" Battery Packs Required

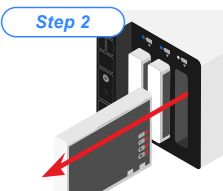
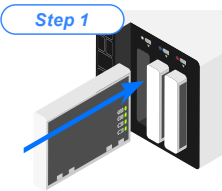

• Medium Power-Intensive Loading (40W-90W)

User scenario	$40W < DC1 + DC2 + USB-C < 90W$
Minimum battery pack required	2
Battery charging behavior	<p>Step 1: Insert the fully charged battery into the slot Step 2: hot-swap one low-charge battery at a time</p> <div></div>
24 / 7 support	The charging dock keeps spare batteries fully charged for immediate replacement.

"Two" Battery Packs Required

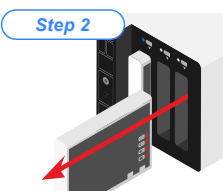
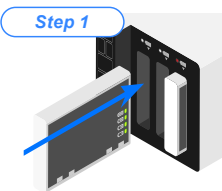

• Low Power-Intensive Loading (Under 40W)

User scenario	$DC1 + DC2 + USB-C < 40W$
Minimum battery pack required	1
Battery charging behavior	<p>Step 1: Insert the fully charged battery into the slot Step 2: hot-swap one low-charge battery at a time</p> <div></div>
24 / 7 support	The charging dock keeps spare batteries fully charged for immediate replacement.

"One" Battery Pack Required



9000mAh Hot Swappable Battery Packs

Enjoy reliable performance with a high-capacity Lithium-ion battery pack capacity of 9,000mAh (97Wh), delivering up to 100W DC output and easy maintenance. The batteries is also compatible with IEI POCm/MPOCm/POCi series products.

IEI TC-202GA Battery Pack	
P/N	31603-000106-RS
Typical Capacity	9000 mAh / 97 Wh
Nominal Voltage	10.8V
Maximum Charge Current	4 A
Maximum Discharge Current	5 A



• Individual Battery Status Indicators

Users can easily monitor the remaining battery capacity in real-time, which assists in identifying when a battery needs recharging or replacement, thereby improving overall maintenance.

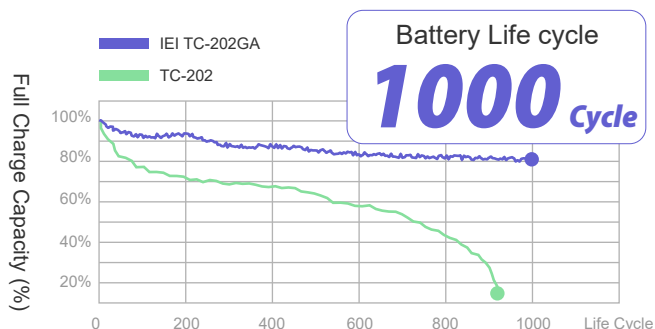
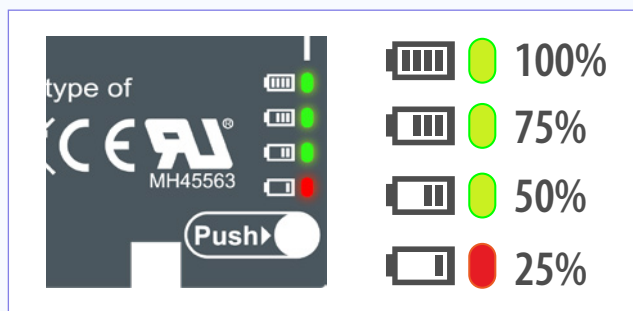

• Life Cycle Breakthrough

IEI's latest TC-202GA Battery features the new generation battery cell with the innovative discharge mechanism, which reduces the power decline rate, thereby doubling the battery's life cycle.

System Battery Status Indicators

Clear visual indicators make it easy for users to understand the health and charge status of the batteries, ensuring preparedness for power outages. They can alert users to low battery levels (0%-10%) and potential battery wear, prompting timely maintenance or replacements.



Fast Charging

Save time with fast charging capabilities that reduce charging time from 0% to 100% to less than 3.5 hours.

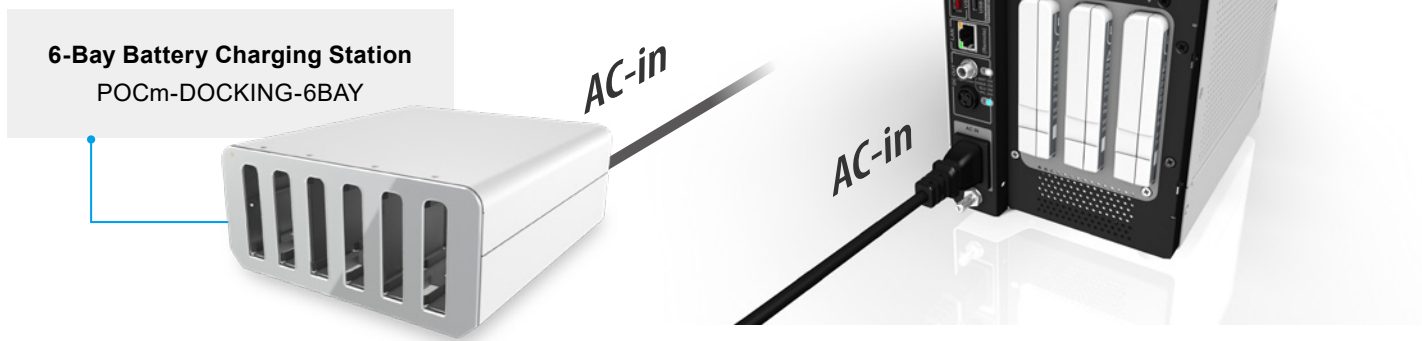

Versatile VESA Mountable and Desktop Options

The IEI AXON-mPOWER offers ultimate flexibility with its VESA 100 compatibility. Whether you need it on a wall, a medical trolley, or as a desktop unit, this device seamlessly integrates into your workspace.

• Wall Mount

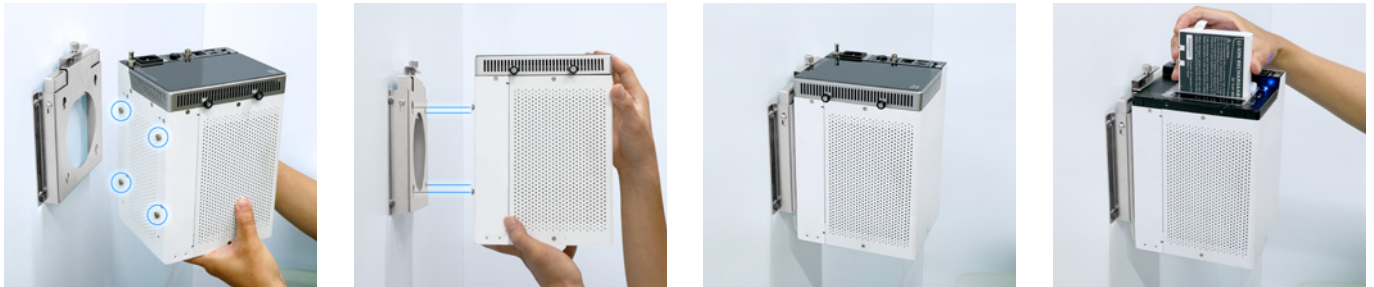

• Medical Trolley VESA Mount











• Desktop



Universal Compatibility

With universal compatibility, it supports USB Type-C, DC Out 1, and DC Out 2 connections, providing power for essential equipment such as medical panel PCs, barcode readers, thermal printers, and vital sign monitors. Its versatile port options make it the ideal power solution for healthcare environments, optimizing productivity and minimizing downtime.

Maximum Port Output

- USB-C  — — — — — **15W**
- DC Out 1  — — — — — **100W**
- DC Out 2  — — — — — **100W**
- DC Out 1  + DC Out 2  — — — — — **125W**
- DC Out 1  + DC Out 2  + USB-C  — — **140W**

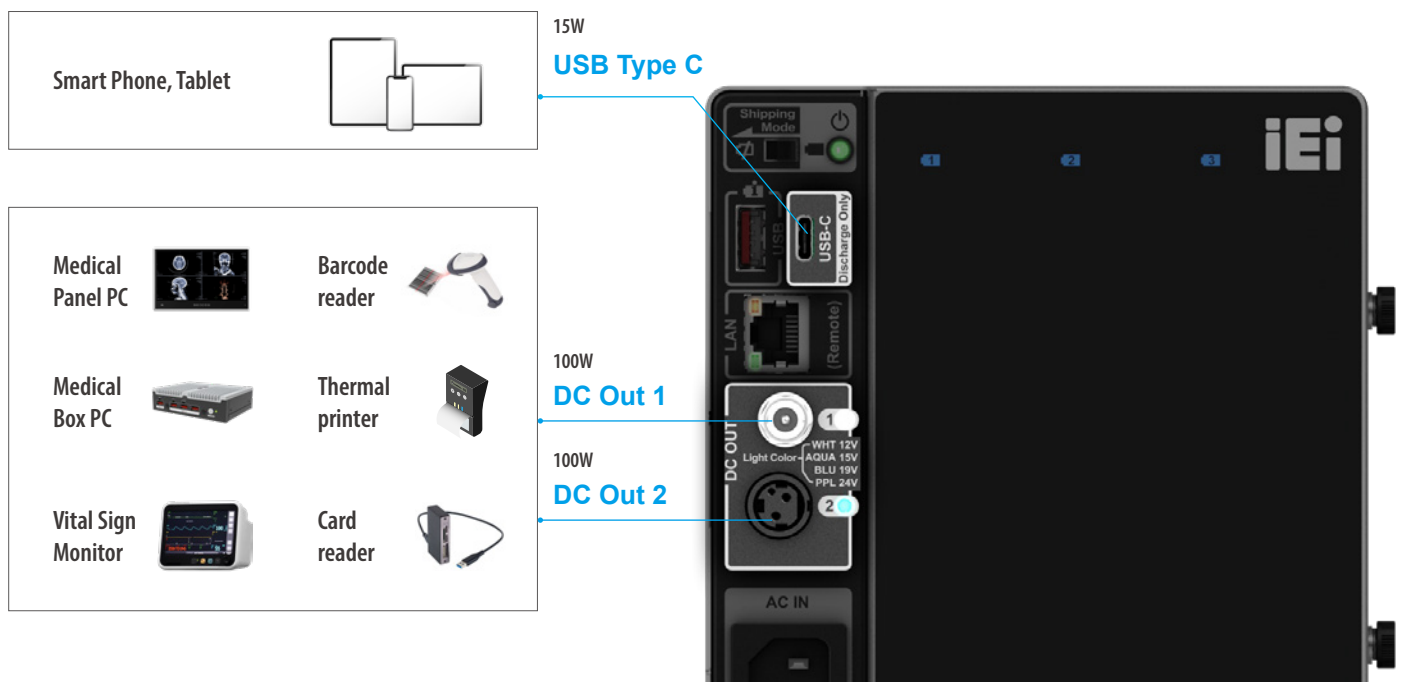

- **Power Output Conditions**

The total power output is determined by the number of battery packs used or whether a PSU is being used.

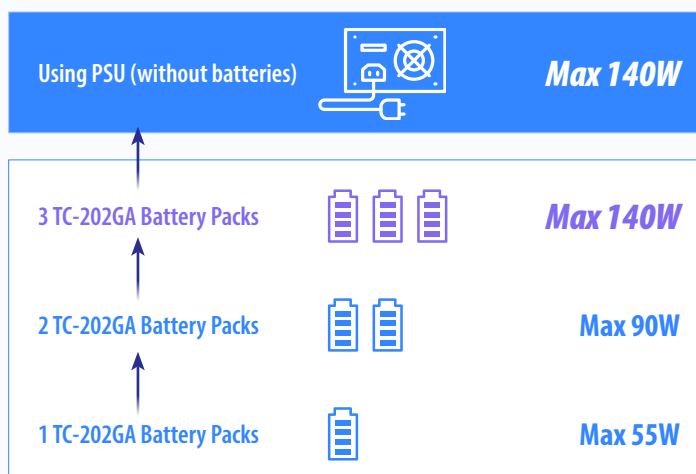

● User Configurable DC Output



Protect your devices by configuring the two DC output ports to meet your specific needs, with the option to set the DC output to 12V, 15V, 19V, or 24V, ensuring protection for a variety of devices.



DC OUT1

Selectable 12V, 15V, 19V, 24V
(maximum of 100 watts)

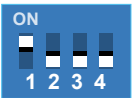
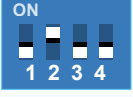

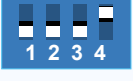

Switch Setting	1	2	3	4
24V 	On	Off	Off	Off
19V 	Off	On	Off	Off
15V 	Off	Off	On	Off
12V 	Off	Off	Off	On

DC OUT2

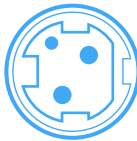
Selectable 12V, 15V, 19V, 24V
(maximum of 100 watts)

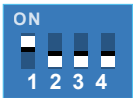

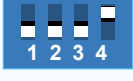
Switch Setting	1	2	3	4
24V 	On	Off	Off	Off
19V 	Off	On	Off	Off
15V 	Off	Off	On	Off
12V 	Off	Off	Off	On

● DC Output Voltage Indicators

- 1



White
12V DC Output
- 1



Aqua
15V DC Output
- 1



Blue
19V DC Output
- 1



Purple
24V DC Output



I/O Interface

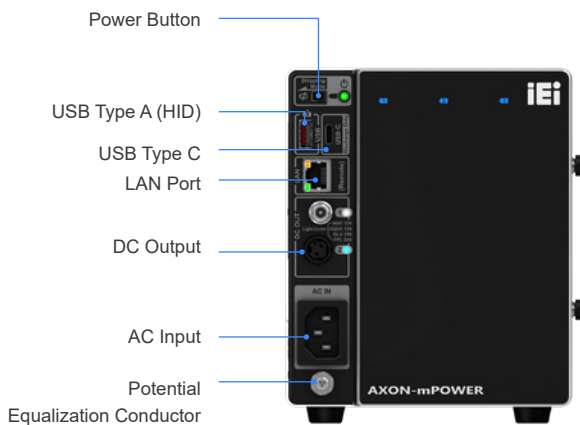

Indicators

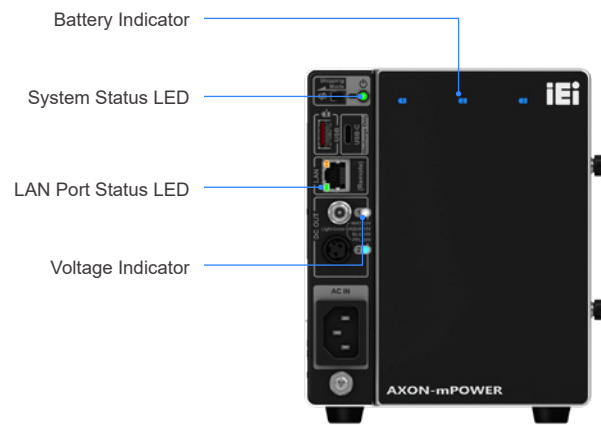

Specifications

Model		AXON-mPOWER-R10
I/O	I/O	1 x LAN: Web-based, specification 10/100Mbps with RJ-45 connection, Cat. 5 cable 2 x DC outputs 1 x USB Type C: 5V/ 3A(Max: 15W, Discharge Only) 1 x USB Type A (HID) 1 x AC-in: C13 connector 1 x Power on/off button
		DC out 1: Selectable 12V/15V/19V/24V (Max: 100W*) CONN MALE; DC JACK 5.5*2.1; DIP; 3PIN; 90°; SHEN MING; 655-196; SPRING WASHER+NUT; PBT; RoHS DC out 2: Selectable 12V/15V/19V/24V (Max: 100W*) JACK; DIP; 3PIN; 90°; BLACK; JKCR; MD-09038-3; Rating: 24VDC/9A; PBT; FEMALE; CCL; RoHS * DC out 1 + DC out 2 ≤ 125W
LED Indicator	LED Indicator	1 x System Status LED 2 x DC Output LED 3 x Battery LED
Physical	Thermal	Smart Fan
	Mounting	VESA 100 x 100 mm
Battery	Battery Pack Type	3 x 3S3P cells Lithium-ion Battery
	Battery Pack Capacity	3 x 9000 mAh (3 x 97Wh)
	Normal Voltage	10.8 V
	Battery Life Time	1000 cycles (FCC ≥ 70% of the minimum capacity)
	Charge Voltage	12.6 V
	Continuous Charge Current	2 A for each battery
	Continuous Discharge Current	4 A for each battery pack
	Maximum Discharge Current	5 A for each battery pack
Power	Discharge Cut-off Voltage	9 V
	Input	100 – 240 VAC
Environment	Built-in Power Supply	260W medical
	Operating Temperature	0°C – 40°C
	Storage Temperature	-20°C – 60°C
	Humidity	10% – 95% (non-condensing)
	Vibration	1G
	Operating shock	5G peak acceleration (11ms duration)
Certification	Non-operating shock	15G peak acceleration (11ms duration)
	EMC & Safety	FCC Part15B EN 62368-1 Ed.2 (60601-1 Compatible) EN 55032 + EN 55035 (60601-1-2 Compatible) Battery Pack: UN38.3, IEC62133, IEC62368-1, UL2054

Ordering Information

Part No.	Description
AXON-mPOWER-R10	VESA 100, 100-240VAC 260W built-in medical grade power supply, 2*configurable DC output, support 3*TC-202GA battery slots, w/o battery, R10
AXON-mPOWER-1B-R10	VESA 100, 100-240VAC 260W built-in medical grade power supply, 2*configurable DC output, support 3*TC-202GA battery slots, w/ 1 pcs battery, R10
AXON-mPOWER-2B-R10	VESA 100, 100-240VAC 260W built-in medical grade power supply, 2*configurable DC output, support 3*TC-202GA battery slots, w/ 2 pcs battery, R10
AXON-mPOWER-3B-R10	VESA 100, 100-240VAC 260W built-in medical grade power supply, 2*configurable DC output, support 3*TC-202GA battery slots, w/ 3 pcs battery, R10

Packing List

Item	Q'ty	Remark
Power Cord	1	European power cord, 183 cm, C13
32002-011100-100-RS	1	DC Out2 POWER CABLE;1000mm;(A) POWER DIN PLUG 3P WITH LOCK;(B) POWER DIN PLUG 4P WITH LOCK

Options

Number	Description
TC-202GA (31603-000106-RS)	3S3P Li-ion battery pack, 10.8V, 9000mAh, CTO only (for eco packing, the order should be at least 14 pcs per box or multiple of 14 pcs)
TC-202GA (MEDP-HSBAT2-R10)	3S3P Li-ion battery pack, 10.8V, 9000mAh with safety shipping BOX (for eco packing, the order should be at least 14 pcs per box or multiple of 14 pcs)
POCm-DOCKING-6BAY-R11	6 Bay Smart Charging Docking, with internal 300 watts PSU, Stackable, Fast Charging, R11



Dimensions (Unit: mm)

