

Setup Intelligent PoE Management System

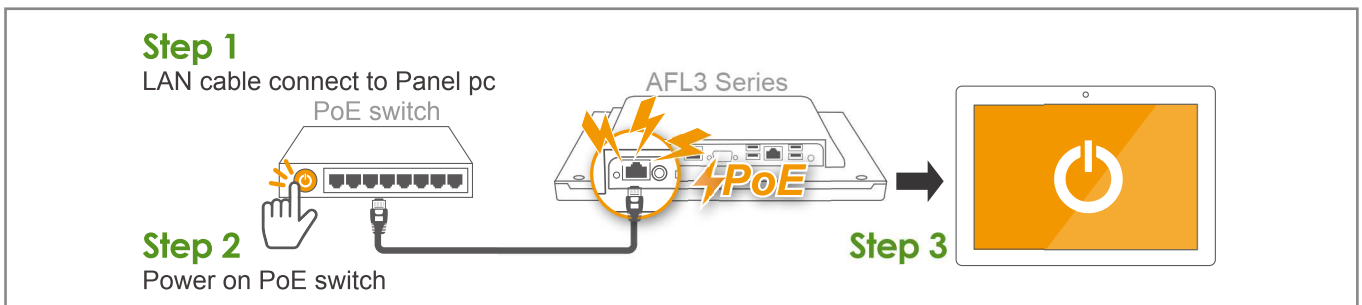

IEI AFL3 PoE Product Support List

The AFL3 series uses DC adapter as a default to connect with power source. The following PoE PD modules provide additional options for powering up the system.

Item	System power consumption (Watts)		IEEE802.3 PD module (Power device)			IEEE802.3 PSE switch (Power sourcing equipment)	
	MAX Load	Idle	AFL3-PD-BT01-KIT01 input power 71~90W	GPOE-PD-AT01 input power 25.5W	GPOE-PD-BT01 input power 71~90W	IEEE802.3at switch Output power 30W	IEEE802.3bt switch Output power 90W
AFL3-W07A-AL*	32.35	12.28	n/a	on board	n/a	✓	✓
AFL3-W07A-AL2*	32.35	12.28	n/a	on board	n/a	✓	✓
AFL3-W10A-AL*	33.66	16.37	✓	n/a	n/a	✓	✓
AFL3-12A-AL	43.1	25.57	✓	n/a	n/a	n/a	✓
AFL3-W15A-AL	42.59	24.46	✓	n/a	n/a	n/a	✓
AFL3-W15C-ULT5*	60.9	19.72	n/a	✓	✓	✓	✓
AFL3-W19C-ULT5*	58.67	17.93	n/a	✓	✓	✓	✓
AFL3-W22C-ULT5*	58.92	20.495	n/a	✓	✓	✓	✓

*The maximum load power consumption of the system exceeds the output power range of the PSE at switch; therefore, it is suggested to connect only lower-power devices (such as keyboard, mouse, UFD or card reader) to the USB ports.



**Two PoE PD module to do power Load sharing
25.5W + 25.5W = 51W**

Customers who is unable to upgrade their PSE switch to IEEE802.3bt standard can simply upgrade the WHL-U panel PC by installing IEI's GPOE-PD-AT01 module, and power the device with two IEEE802.3at standard PSE ports