

HDC-701EL

PCI Express video/audio capture card with One Channel HDMI/DP/DVI-I/YPbPr/3G-SDI Input and One Channel HDMI Output, 1920x1080@30p, and H.264 Hardware Encoder

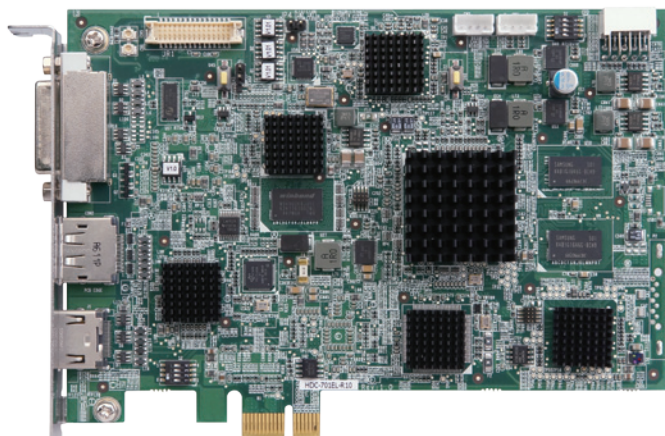

Features

- 1-channel HDMI/DP/DVI-I/YPbPr/3G-SDI input with H.264 hardware compression and 1-channel HDMI output
- High quality video recording up to 1080p30
- HDMI output supports video preview up to 1080p60, so you can watch video while recording or editing
- Provides DirectShow filter
- Equipped with video scaler for PIP, OSD, cropping (optional)
- Windows/Linux OS supported

Specifications

◆ Interface

Input	Video input channel	1 channel
	Video input type	HDMI/DP/DVI-I/YPbPr/3G-SDI
	Audio input channel	1 channel
	Audio input type	HDMI (stereo video)
Output	Video output channel	1 channel (1080p 60)
	Video output type	HDMI
	Audio output channel	1 channel
	Audio output type	HDMI (stereo)

◆ PC Interface

Type	PCIe x1
------	---------

◆ Video Processing

Hardware Encoder	H.264/AVC High Profile Level 4.1	
Recording Datarate	Up to 30Mbps	
Video Input Resolution	1920 x 1080 24p/25p/30p/50p/60p 1920 x 1080 60i/59.94i/50i	1280 x 1024 30p 1280 x 768 60p 1024 x 768 60p 720 x 576 50p 640 x 480 60p
	1280 x 800 60p 1280 x 720 50p/60p 800 x 600 60p 720 x 480 60p	1280 x 1024 30p 1280 x 768 60p 1024 x 768 60p 720 x 576 50p 640 x 480 60p
Recording Formats	1920 x 1080 24p/25p/30p 1280 x 800 60p 1280 x 720 50p/60p 800 x 600 60p 720 x 480 60p	1280 x 1024 30p 1280 x 768 60p 1024 x 768 60p 720 x 576 50p 640 x 480 60p
	1920 x 1080 24p/25p/30p 1280 x 800 60p 1280 x 720 50p/60p 800 x 600 60p 720 x 480 60p	1280 x 1024 30p 1280 x 768 60p 1024 x 768 60p 720 x 576 50p 640 x 480 60p

◆ Audio Processing

Audio Sampling Frequencies	44.1k, 48k Hz
Audio Compression	MPEG4-AAC
Recording Datarate	128kbps

H.264 Hardware Encoder

Video Recording/Streaming

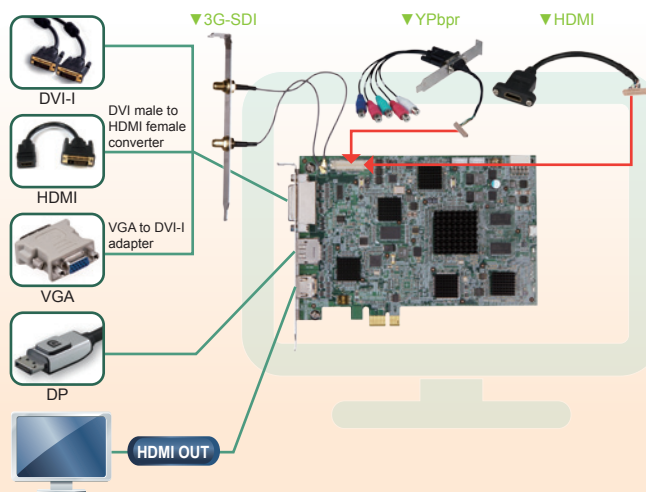

Dimensions (Unit: mm)

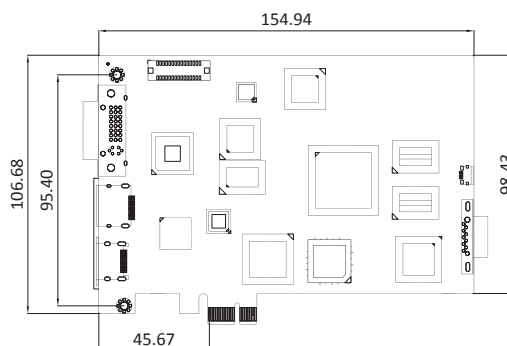

◆ System Requirement

System	Intel® Core™2 Duo 2.4GHz or above
Memory	2GB or more

◆ Software Support

OS Support	Microsoft Windows 7 32-bit/64-bit Linux: Ubuntu 16.04 (64-bit) (Kernel version: 4.4.0-21-generic)
SDK	Windows: Provides SDK and demo program with sample source code Linux: Provides SDK and demo program with sample source code

◆ Functionality

Multiple Card Support	4 cards, 4 channels
Scaling	Video scaling support, OSD, PIP, Cropping

◆ Others

Dimensions	155 mm x 111 mm
Operating Temperature	0°C ~ 60°C (32° ~ 140°F), non-condensing
Power Consumption	15W

Packing List

1 x HDC-701EL	
1 x QIG	1 x Utility CD

Ordering Information

Part No.	Description
HDC-701EL-R10	PCI Express video/audio capture card with one channel HDMI/DP/DVI-I/YPbPr/3G-SDI input and one channel HDMI bypass output, 1920x1080@30p, and H.264 hardware encoder