

# IEM-945GSE-N270-R11

ETX 3.0 CPU Module with Intel® Atom™ processor, VGA/LVDS, LAN, SATA, USB and Audio

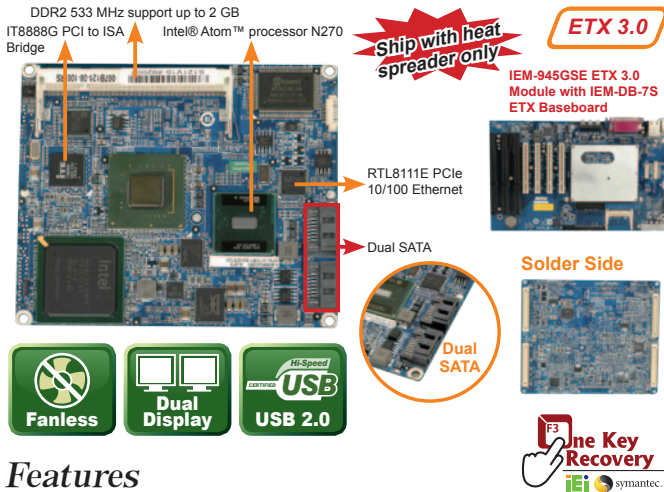

## Features

- ETX 3.0 CPU module with two on-board SATA 1.5Gb/s ports
- Support four PCI, one ISA slot for expansion
- Support dual display for VGA + LVDS
- Support four USB 2.0, two SATA, one IDE interface
- IEI One Key Recovery solution allows you to create rapid OS backup and recovery

## Specifications

- ◆ CPU  
Intel® Atom™ processor N270 1.6 GHz with 533 MHz FSB
- ◆ System Chipset  
Intel® 945GSE + Intel® 82801 GBM/ICH7M
- ◆ BIOS  
AMI
- ◆ System Memory  
One 200-pin 533/400 MHz DDR2 SO-DIMM supported (system max. 2 GB)
- ◆ Ethernet  
One 10/100Mbps Realtek RTL8111E Ethernet chipset (PCIe interface)
- ◆ Super I/O  
ITE IT8718
- ◆ I/O Interface  
4 x USB 2.0 (to baseboard)  
2 x RS-232 (to baseboard)  
2 x SATA (on CPU module)  
1 x IDE (to baseboard)  
1 x LPT (to baseboard)  
1 x PS2 KB/MS (to baseboard)
- ◆ Expansions  
4 x PCI, 32-bit 33 MHz PCI bus to baseboard  
ISA supported by ITE IT8888G
- ◆ Display Interface  
VGA/TV-Out integrated in Intel® 945GSE (to baseboard)  
18-bit dual-channel LVDS signal (to baseboard)
- ◆ Watchdog Timer  
Software programmable supports 1~255 sec. system reset
- ◆ Power Supply  
AT/ATX supported
- ◆ Power Consumption  
5V@2.9A (Intel® Atom™ processor N270 with 1 GB DDR2)
- ◆ Operating Temperature  
0°C ~ 60°C
- ◆ Operating Humidity  
5% ~ 95%, non-condensing
- ◆ Dimensions  
95 mm x 114 mm
- ◆ Weight  
GW: 600g/NW: 250g

## Dimensions (mm)

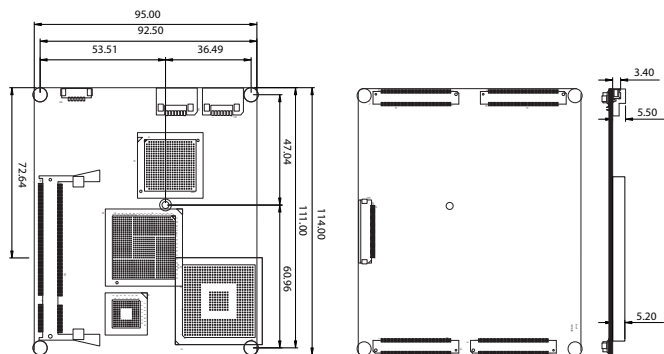

## Packing List

1 x IEM-945GSE single board computer	1 x One Key Recovery CD
1 x Heatspreader	1 x Utility CD      1 x QIG

## Ordering Information

Part No.	Description
IEM-945GSE-N270-R11	ETX 3.0 module with Intel® Atom™ processor N270 1.6G, VGA/LVDS, LAN, USB, SATA and audio
IEM-DB-7S-RS-R30	ATX size 7-slot ETX baseboard
34000-000244-RS	Heatsink for IEM-945GSE

# IEM-LX-800-R11

AMD Geode™ LX 800 Highly Integrated ETX Module

ETX CPU Module with on-board AMD Geode™ LX 800, USB 2.0, LAN & Audio

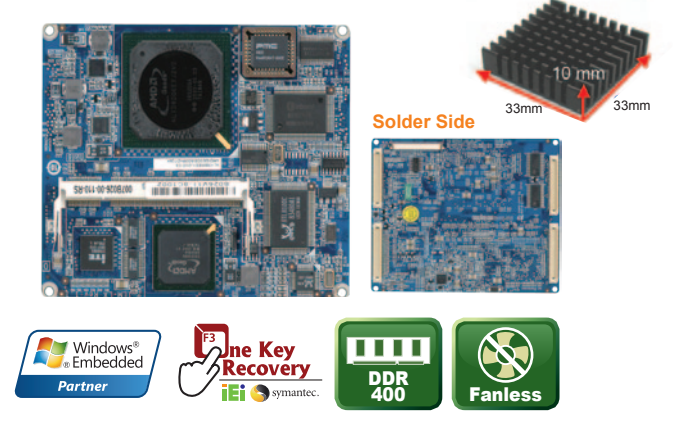

## Specifications

- ◆ CPU  
On-board AMD Geode™ LX 800 (500 MHz) processor
- ◆ System Chipset  
AMD Geode™ LX 800 + AMD CS5536
- ◆ BIOS  
Award BIOS
- ◆ System Memory  
One 200-pin 400/333 MHz DDR SDRAM SO-DIMM supported (system max. 1 GB)
- ◆ Ethernet  
10/100Mbps RTL8100C Ethernet chipset
- ◆ I/O Interface  
4 x USB 2.0  
1 x IDE      2 x RS-232  
1 x PS/2 KB/MS      1 x LPT/FDD
- ◆ Expansions  
4 x PCI bus master  
ISA support by ITE IT8888G
- ◆ Audio  
Realtek ALC203 AC'97 codec
- ◆ SSD  
CF Type II
- ◆ Super I/O  
Winbond W83627EHG
- ◆ Display Interface  
VGA integrated in AMD Geode™ LX 800  
24-bit TTL (optional)  
18-bit single-channel LVDS
- ◆ Watchdog Timer  
Software programmable supports 1~255 sec. system reset
- ◆ Power Supply  
AT/ATX support
- ◆ Power Consumption  
5V@0.92A (AMD Geode™ LX 800 CPU with DDR 333 MHz 256MB RAM)
- ◆ Operating Temperature  
0°C ~ 60°C (32°F ~ 140°F)
- ◆ Storage Temperature  
-10°C ~ 70°C
- ◆ Operating Humidity  
5% ~ 95%, non-condensing
- ◆ Dimensions  
95 mm x 114 mm
- ◆ Weight  
GW: 650g/NW: 250g

## Dimensions (mm)

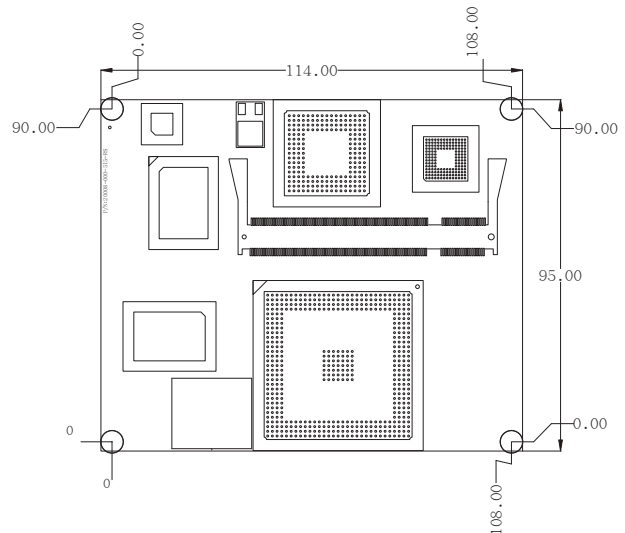

## Packing List

1 x IEM-LX single board computer	1 x One Key Recovery CD
1 x Screw kit	1 x Utility CD      1 x QIG

## Ordering Information

Part No.	Description
IEM-LX-800-R11	AMD Geode™ LX 800 500 MHz processor, VGA/LVDS/TTL, LAN & Audio